

Note: Dimensions are nominal measurements only

SPECIFICATIONS

RECOMMENDED USE

Domestic

MATERIAL

Stainless Steel
Plywood
Glass Mirror

MOUNTING HARDWARE INCLUDED

Yes, 2x Wall Brackets
8x Phillips Head Screws

INSTALLATION GUIDE

Note: This product must be installed by a licensed tradesperson.

This is a general installation guide - there are many factors that are involved that can alter the installation method.

This product install must comply with the standards in your respective country and must be adhered to by your licensed tradesperson.

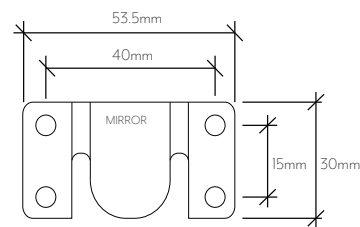
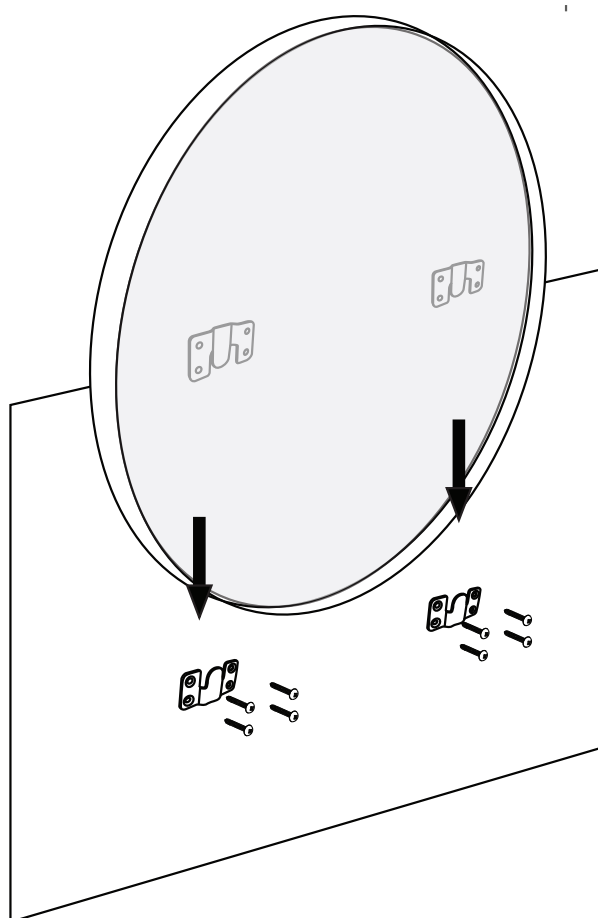
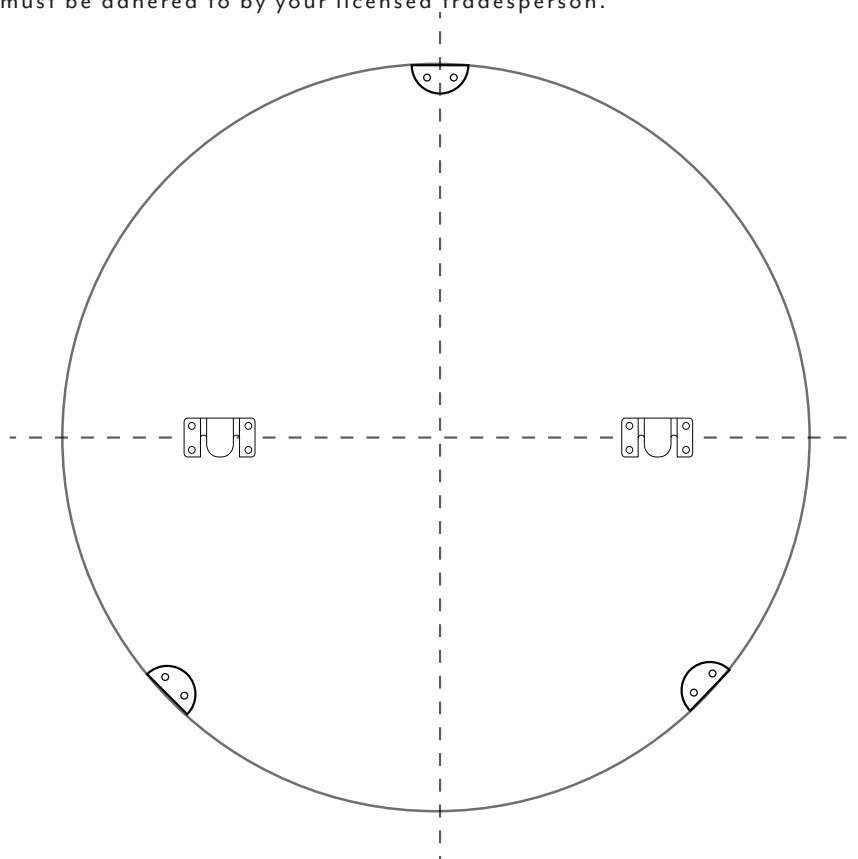

FIXING BRACKETS

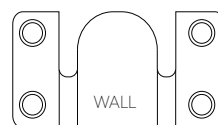

1. Mark desired position up on wall
2. Fix brackets in position on the wall using appropriate fixings and plugs if necessary. Tip: Use a level to ensure the brackets are installed at the same height!
3. Line up and fix brackets onto back of mirror using supplied screws
4. Slot the mirror brackets into the wall brackets



Regularly clean with mild liquid detergent or soap and water.



DO NOT use cream cleaners or bleach. These substances are abrasive.



DO NOT use cleaning pads with abrasive surfaces as this may scratch the material.