

Top View

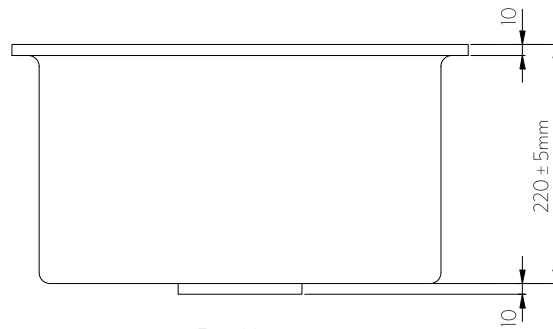

Front View

Note: Dimensions are nominal measurements only

SPECIFICATIONS

RECOMMENDED USE

Domestic/Commercial

MATERIAL

Composite Black Granite

INSTALLATION

Undermount, Top Mount

OVERFLOW

No

CAPACITY

19L

RIM THICKNESS

10mm

INSTALLATION GUIDE

This product must be installed by a licensed tradesperson.

This is a general installation guide - there are many factors that are involved that can alter the installation method. This product install must comply with the standards in your respective country and must be adhered to by your licensed tradesperson.



CUT-OUT TEMPLATES

TOPMOUNT INSTALLATION

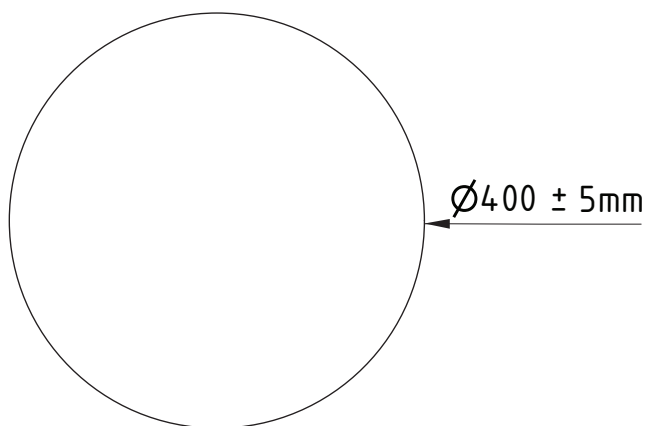

UNDERMOUNT INSTALLATION

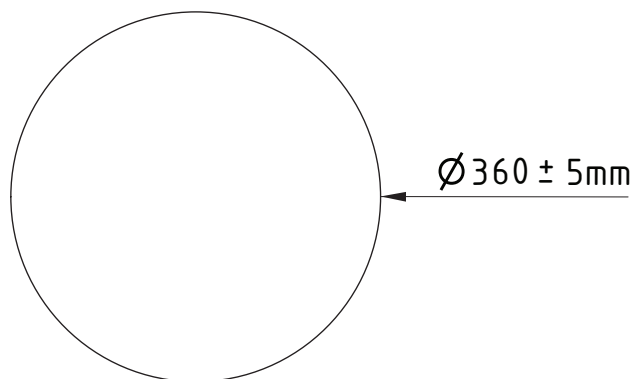

Note: Dimensions are nominal measurements only



Regularly clean with mild liquid detergent or soap and water.



DO NOT use cream cleaners or bleach. These substances are abrasive.



DO NOT use cleaning pads with abrasive surfaces as this may scratch the material.

INSTALLATION GUIDE

This product must be installed by a licensed tradesperson.

This is a general installation guide - there are many factors that are involved that can alter the installation method. This product install must comply with the standards in your respective country and must be adhered to by your licensed tradesperson.



UNDERMOUNT INSTALLATION

- 1 Mark out desired location of sink using the cut out template dimensions provided.

Cut out sink hole using preferred method.

Note: If cutting a stone benchtop it will need to be cut in a controlled environment by a licensed tradesperson as per OH&S regulations.

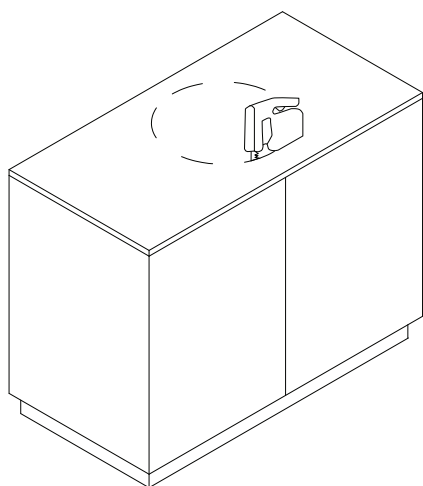

- 2 Clean around the edge of benchtop sink hole & perimeter of sink rim.

Position the sink in the cabinet below the benchtop hole. Apply adhesive sealant to the perimeter of sink rim & lift into position.

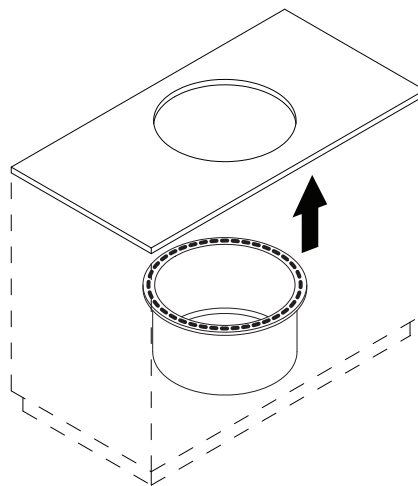

- 3 Lay a piece of timber across the benchtop hole & position in line with sink holes below.

Place clamps through the sink holes & tighten the clamps to hold the sink in place. Wipe away any excess adhesive sealant around benchtop opening.

Note: Use rags to protect surfaces when either the clamp or timber is making contact with the benchtop or sink.

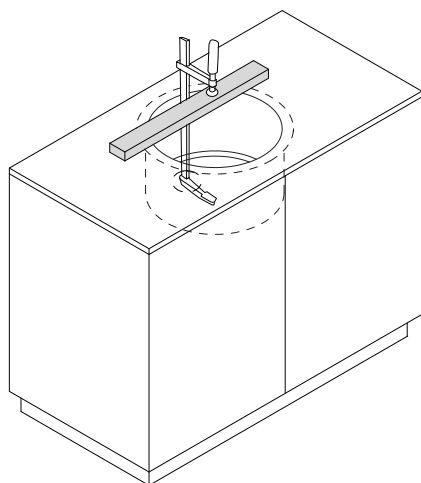

- 4 Using the benchtop material build rebated mounting tabs.

Clean around the underside perimeter of the sink & the mounting tabs.

Apply adhesive sealant to the mounting tab & fix it to the underside of the benchtop & sink rim. Repeat tabs at regular intervals. Wipe away any excess adhesive around mounting tabs.

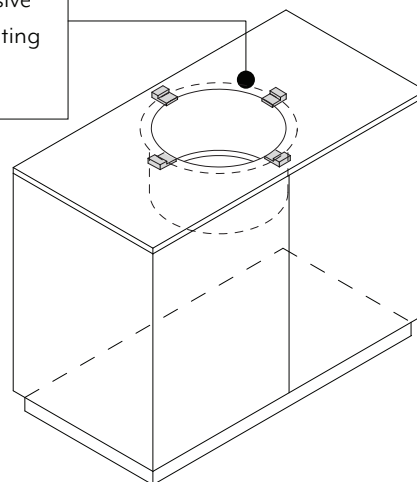
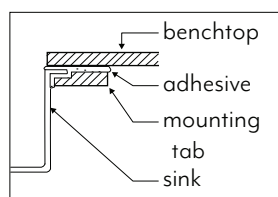

Regularly clean with mild liquid detergent or soap and water.



DO NOT use cream cleaners or bleach. These substances are abrasive.



DO NOT use cleaning pads with abrasive surfaces as this may scratch the material.

INSTALLATION GUIDE

This product must be installed by a licensed tradesperson.

This is a general installation guide - there are many factors that are involved that can alter the installation method. This product install must comply with the standards in your respective country and must be adhered to by your licensed tradesperson.



TOPMOUNT INSTALLATION

- 1 Mark out desired location of sink using the cut out template dimensions provided.

Cut out sink hole using preferred method.

Note: If cutting a stone benchtop it will need to be cut in a controlled environment by a licensed tradesperson as per OH&S regulations.

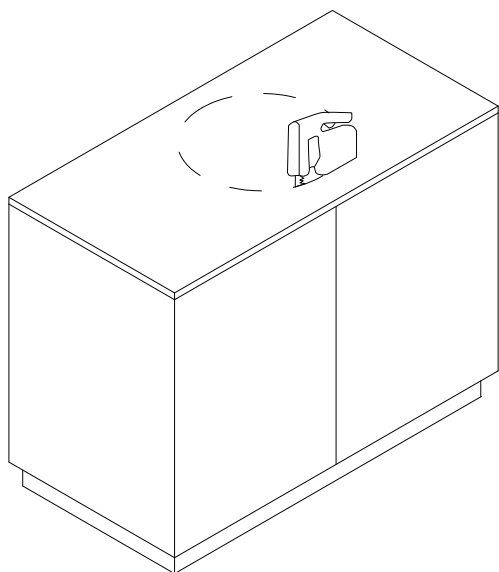

- 2 Clean around edge of benchtop sink hole & perimeter of sink rim.

Apply adhesive sealant to the underside perimeter of sink rim & lower into position.

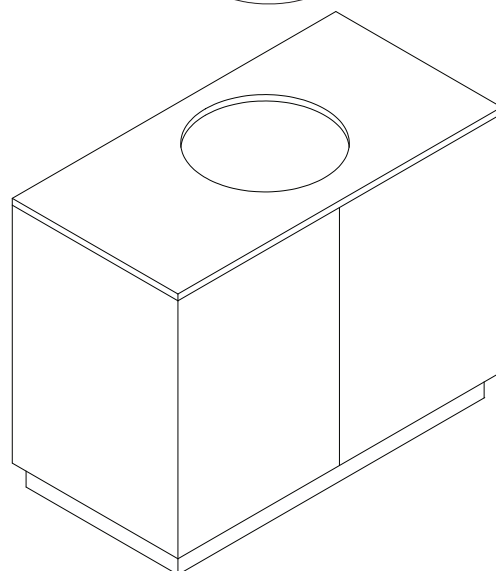
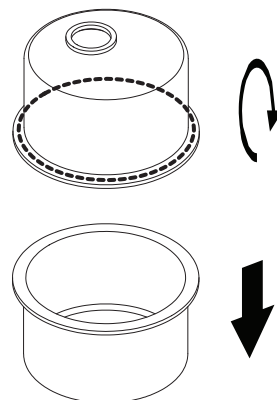

- 3 Wipe away any excess adhesive sealant around sink rim.

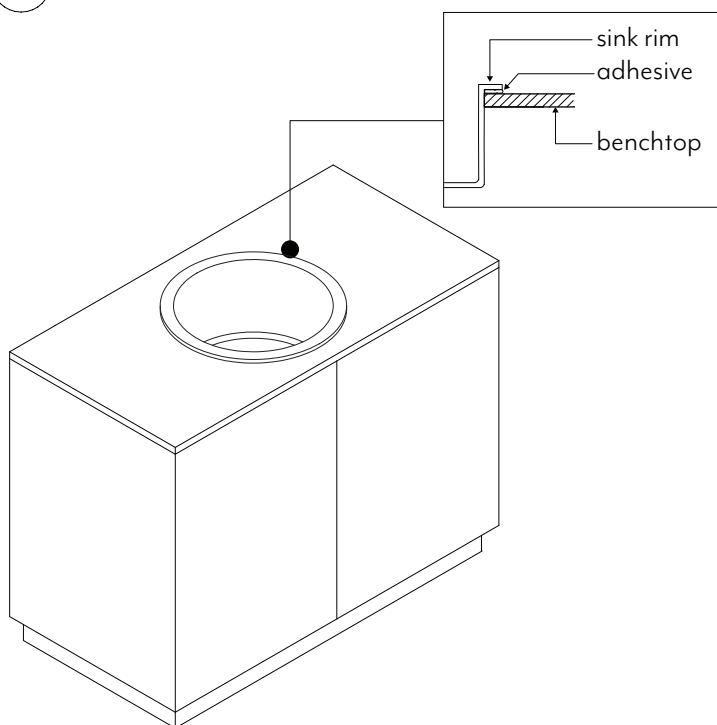

Regularly clean with mild liquid detergent or soap and water.



DO NOT use cream cleaners or bleach. These substances are abrasive.



DO NOT use cleaning pads with abrasive surfaces as this may scratch the material.