

Bottom View

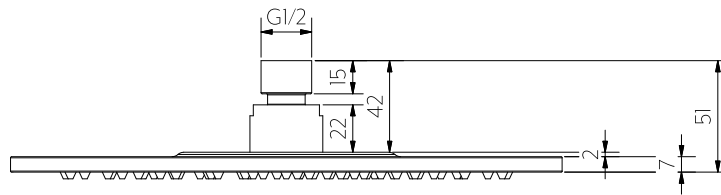

Front View

**Note:** Dimensions are nominal measurements only

## SPECIFICATIONS

### RECOMMENDED USE

Domestic

### MATERIAL

Solid Brass

### TEMPERATURE RATING

Maximum continuous working temperature 75°C  
If the water temperature exceeds 75°C, an approved tempering valve must be fitted

### PRESSURE RATING

Recommended minimum working pressure 0.2 Bar  
Recommended maximum working pressure 5 Bar  
Hot and cold water inlet pressure should be equal

### SUITABLE HOT WATER UNITS

Storage tank: Yes  
Continuous Flow: Yes  
Gravity Feed: Suitable

### WATER EFFICIENCY

Flow Rate 8.5L/min

# INSTALLATION GUIDE

**Note:** This product must be installed by a licensed plumber. This is a general installation guide - there are many factors involved that can alter the installation method. **AU/NZ:** For installations within Australia and New Zealand, this product must be installed in compliance with AS/NZS 3500. **UK:** For installations in the United Kingdom this product must be installed in compliance with the Water Supply (Water Fittings) Regulations and Water Supply (Water Fittings) (Scotland) Byelaws. **Other:** For installations outside these countries, this product must be installed in compliance with the standards in your respective country.





1 Ensure o-ring is fitted inside the ball joint connector.

2 Fasten ball joint and shower head to arm with spanner using a cloth to ensure not to damage finish.

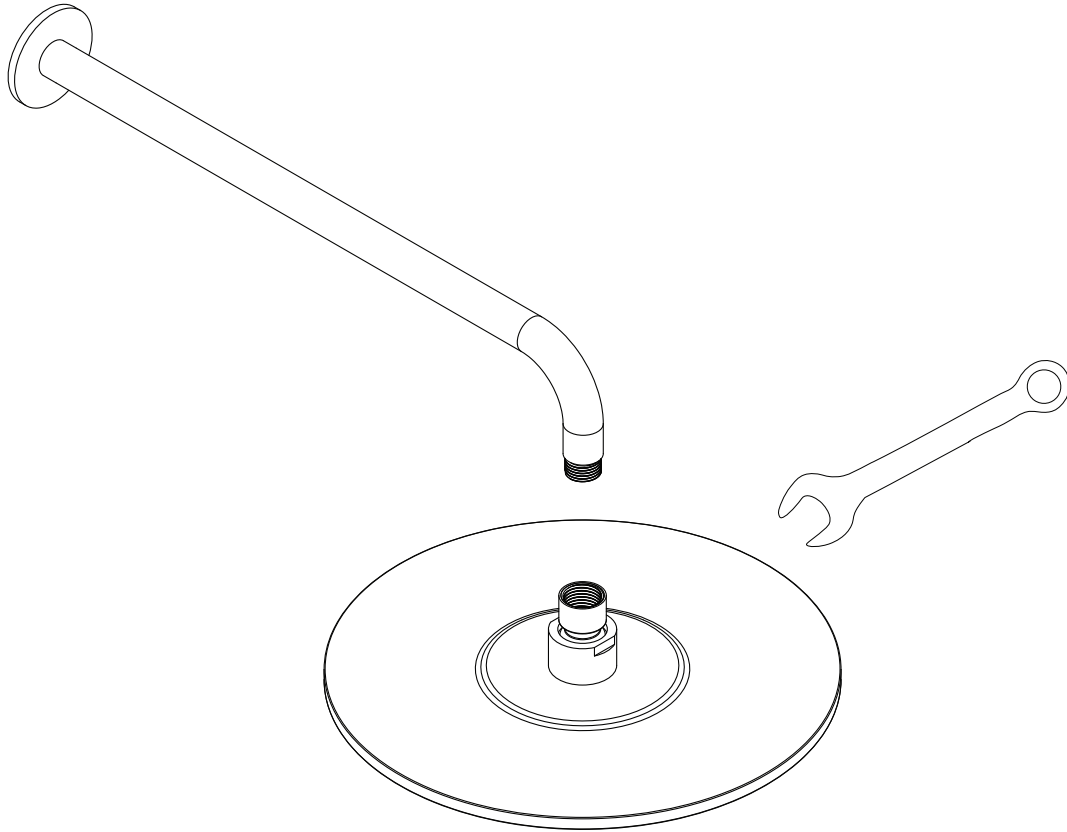
**Note:** Shower arm and back plate not included.



IN THE BOX		1x O Ring
		1x Shower Head



Regularly clean with mild liquid detergent or soap and water



**DO NOT** use cream cleaners or bleach. These substances are abrasive



**DO NOT** use cleaning pads with abrasive surfaces as this may scratch the material