

KINGSLEY ASSEMBLY HANDLE KIT

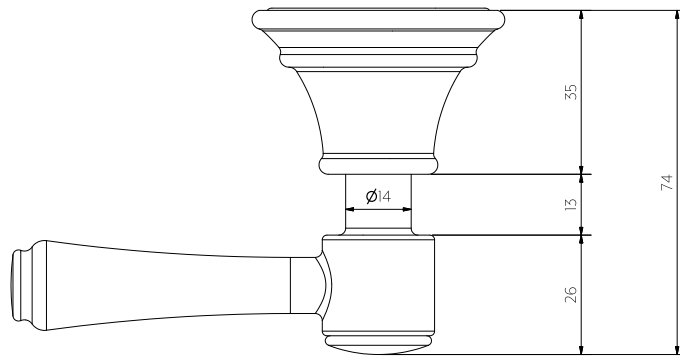

Top View

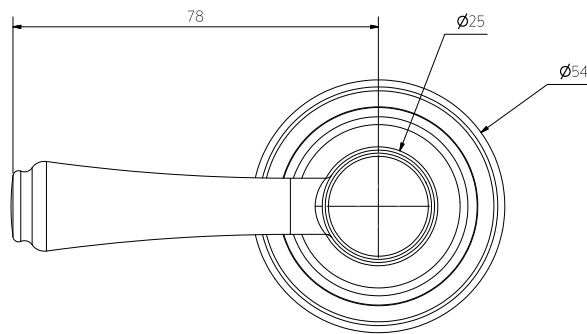

Front View

Note: Dimensions are nominal measurements only

SPECIFICATIONS

RECOMMENDED USE

Domestic

MATERIAL

Solid Brass

INSTALLATION GUIDE

Note: This product must be installed by a licensed plumber. This is a general installation guide - there are many factors involved that can alter the installation method. **AU/NZ:** For installations within Australia and New Zealand, this product must be installed in compliance with AS/NZS 3500. **UK:** For installations in the United Kingdom this product must be installed in compliance with the Water Supply (Water Fittings) Regulations and Water Supply (Water Fittings) (Scotland) Byelaws. **Other:** For installations outside these countries, this product must be installed in compliance with the standards in your respective country.



New Build - Install breach in desired position (please refer to additional install information regarding breach set backs).

Retrofitting Existing - Remove existing tapware & reseal body seats until shiny and smooth.

- 1 Remove locking nut from spindle. Screw spindle into breach and hand tighten until rear of spindle meets the body seat, be sure not to overtighten. If necessary apply more pressure lightly with spanner.

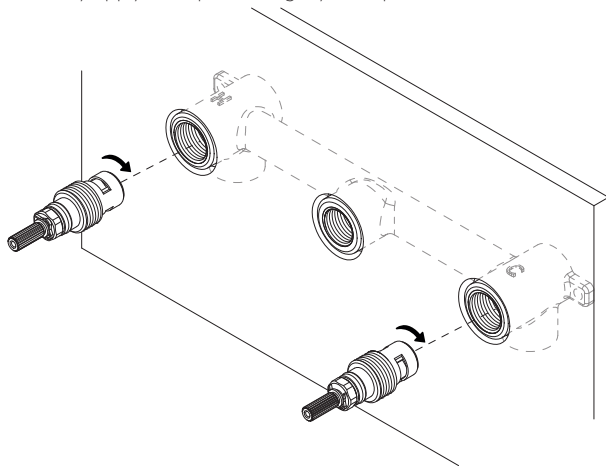

- 2 Fit the fibre washer over the spindle. Screw on the locking nut and tighten with spanner. **TEST AND CHECK FOR LEAKS.**

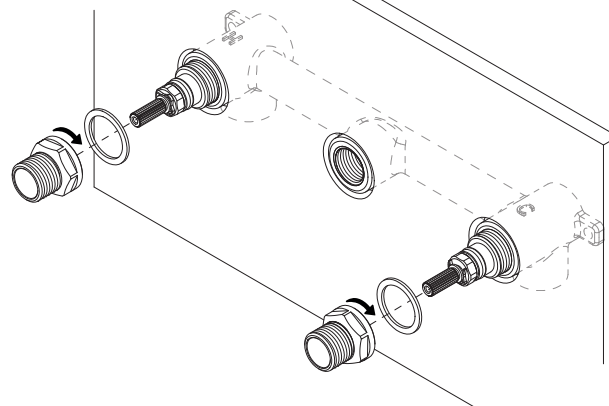

- 3 This product may require a bonnet extender (purchase at local hardware store) that may be required to cover the additional breach depth. Please refer to the following page for breach set back guide. If required, screw bonnet extender on to locking nut.

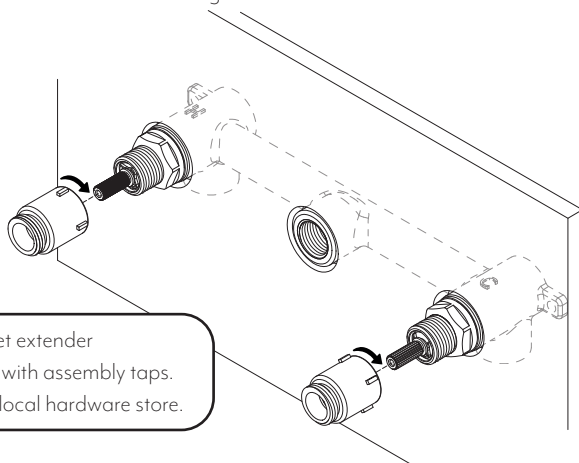

Note: Bonnet extender not included with assembly taps. Available at local hardware store.

- 4 Install the back plate onto the locking nut (or bonnet extender if required), twisting by hand until tightened.

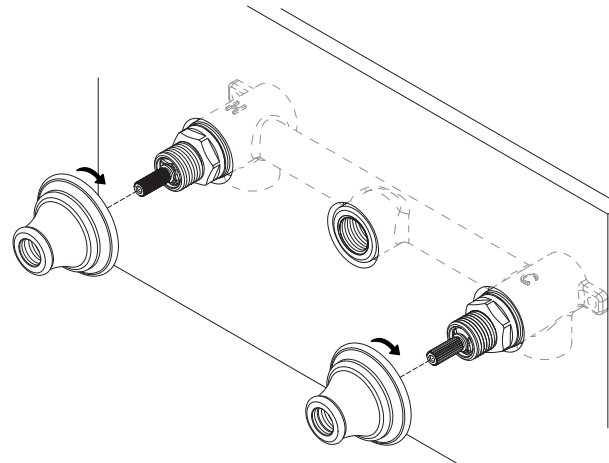

- 5 A 10mm brass spacer is provided to achieve optimum handle spacing from the back plate. Insert spacer into rear side of handle and install handle onto spindle, fixing with a screw and washer.

- 6 Insert handle cap into front of handle.

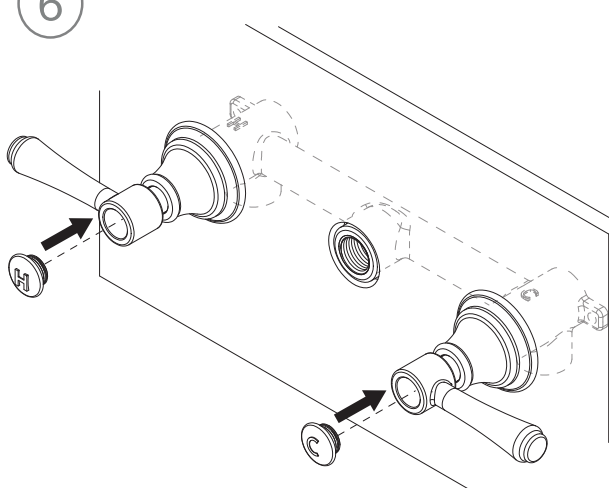

Regularly clean with mild liquid detergent or soap and water.



DO NOT use cream cleaners or bleach. These substances are abrasive.



DO NOT use cleaning pads with abrasive surfaces as this may scratch the material.