

Note: Dimensions are nominal measurements only

SPECIFICATIONS

RECOMMENDED USE

Domestic/ Commercial

MATERIAL

304 Stainless Steel

TEMPERATURE RATING

Maximum continuous working temperature 75°C
If the water temperature exceeds 75°C, an approved tempering valve must be fitted

PRESSURE RATING

Recommended minimum working pressure 0.5 Bar
Recommended maximum working pressure 5 Bar
Hot and cold water inlet pressure should be equal

INSTALLATION GUIDE

Note: This product must be installed by a licensed plumber. This is a general installation guide - there are many factors involved that can alter the installation method. **UK:** For installations in the United Kingdom this product must be installed in compliance with the Water Supply (Water Fittings) Regulations and Water Supply (Water Fittings) (Scotland) Byelaws. **Other:** For installations outside these countries, this product must be installed in compliance with the standards in your respective country.

ABI
INTERIORS

INSTALLATION GUIDE - INCLUDING BOILER UNIT

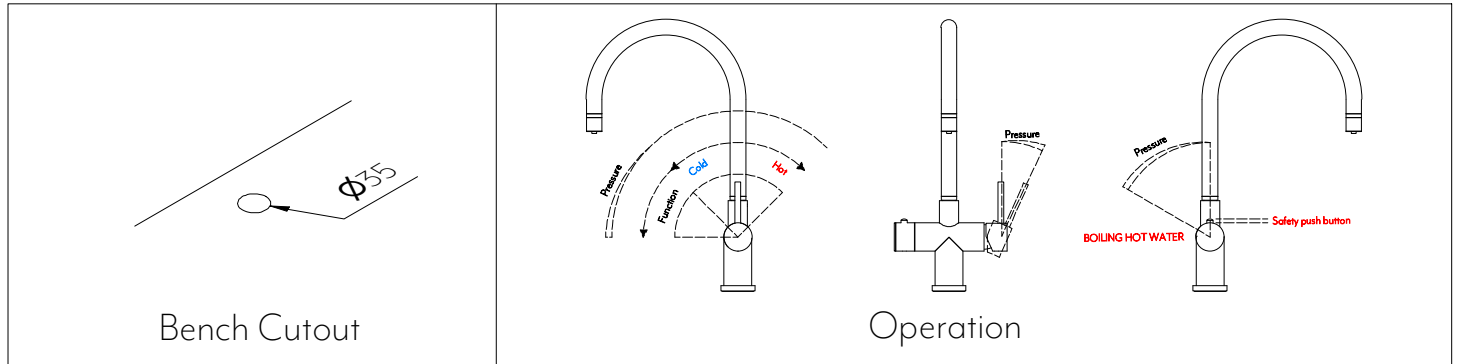

- 1 Remove locking collar and washers.
- 2 Insert into the cut-out and fasten the locking nut.

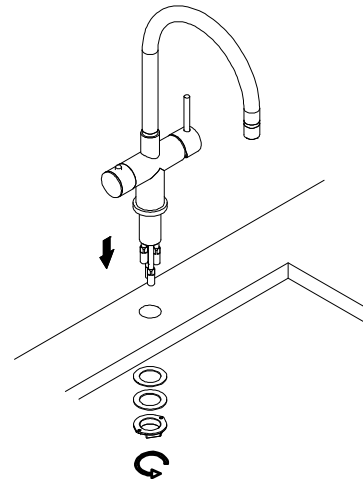
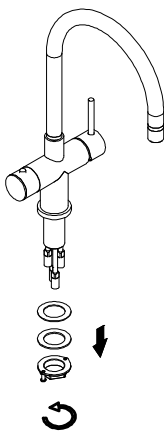

- 3 Fasten the bolts using a screwdriver.
- 4 Attach the flexi-hoses. Do not overtighten.

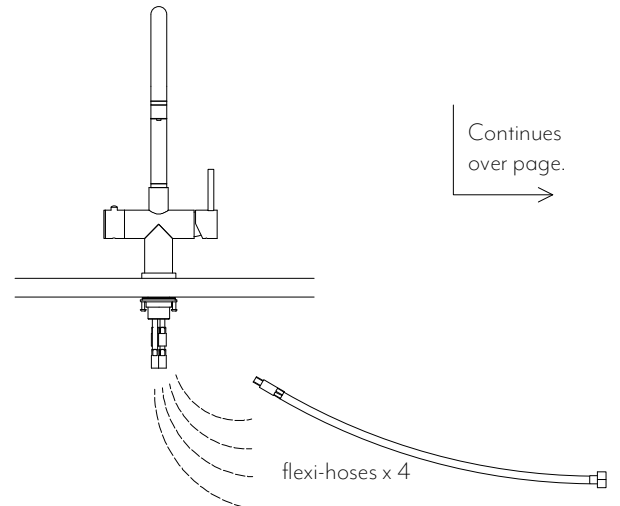
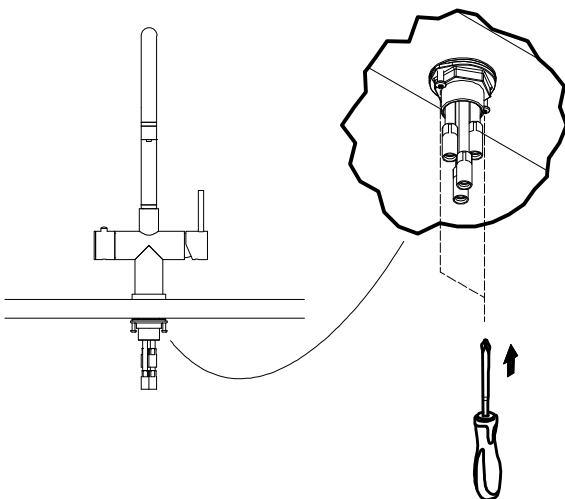

Regularly clean with mild liquid detergent or soap and water



DO NOT use cream cleaners or bleach. These substances are abrasive

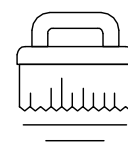

DO NOT use cleaning pads with abrasive surfaces as this may scratch the material

INSTALLATION GUIDE

Note: This product must be installed by a licensed plumber. This is a general installation guide - there are many factors involved that can alter the installation method. **UK:** For installations in the United Kingdom this product must be installed in compliance with the Water Supply (Water Fittings) Regulations and Water Supply (Water Fittings) (Scotland) Byelaws. **Other:** For installations outside these countries, this product must be installed in compliance with the standards in your respective country.









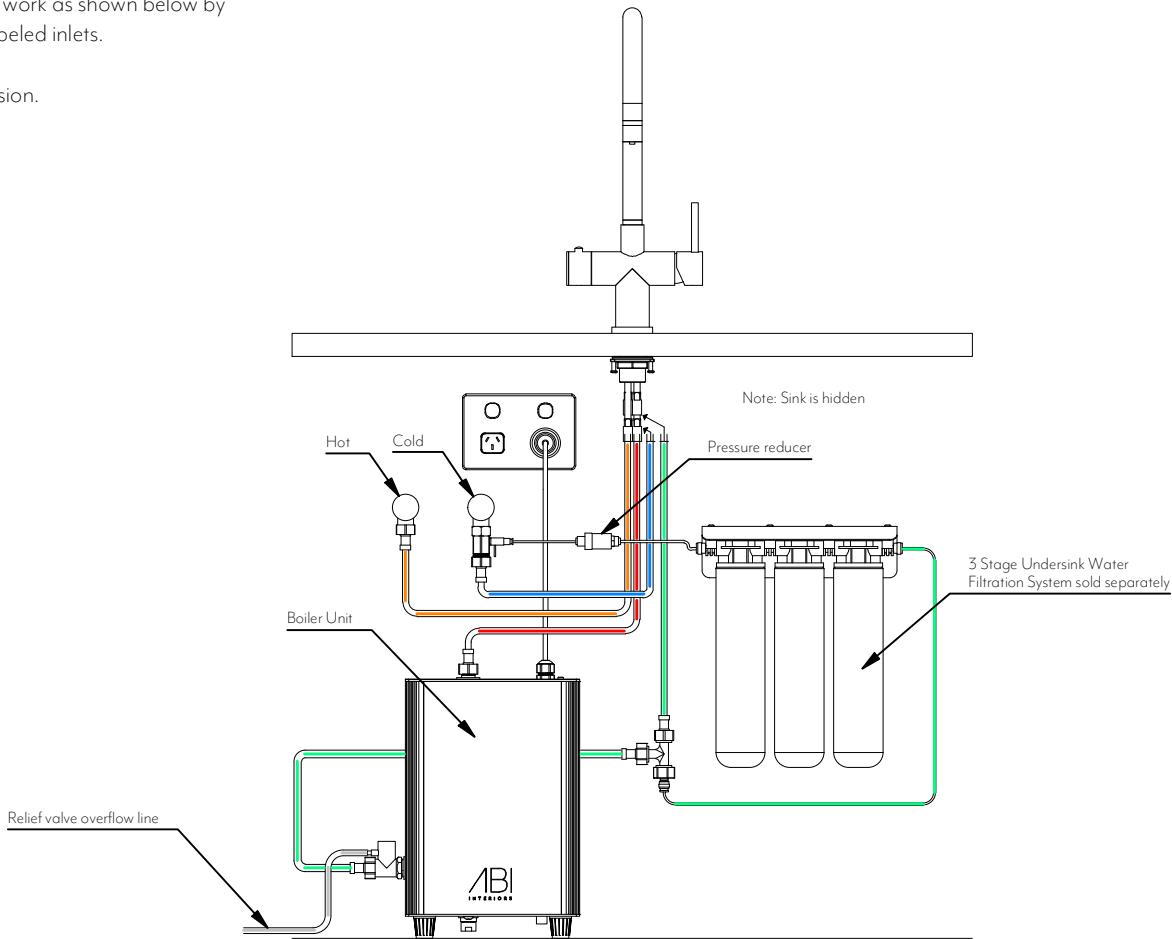

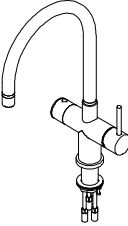
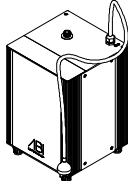
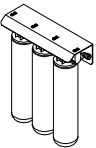
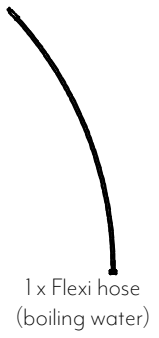
INSTALLATION GUIDE - INCLUDING BOILER UNIT

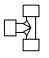
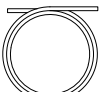
- 5 Connect the pipe work as shown below by referring to the labeled inlets.

Test and commission.

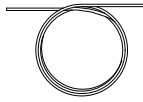

In the box (1)	In the box (2)	Filter sold separately (3)
 1 x Elysian 4-in-1 Kitchen Mixer	 1 x Boiler unit	 1 x 3 Stage Filter Unit
 1 x Flexi hose (boiling water)	 1 x Flexi hoses (standard)	 1 x Filter isolation tee
 1 x GI/2 Tee connector	 1 x Relief hose	 1 x Pressure limiting valve (outlet: 500kpa)
 2x GI/2 to Fridge hose connection	 1 x Pressure relief valve	 1 x GI/2 to Fridge hose connection
 3 x Flexi hoses (male end)	 1 x Metal threaded connector	 1 x Fridge hose (1/4inch x 3m length)



Regularly clean with mild liquid detergent or soap and water



DO NOT use cream cleaners or bleach. These substances are abrasive

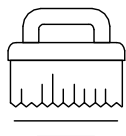

DO NOT use cleaning pads with abrasive surfaces as this may scratch the material

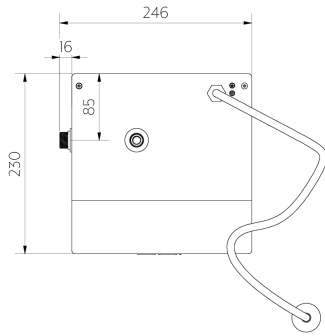

Top View

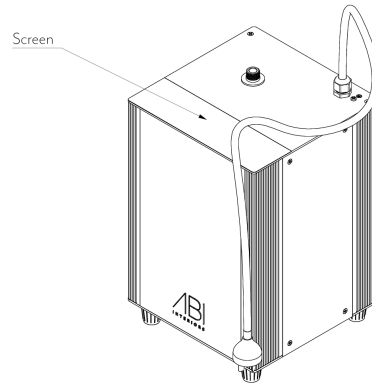

Isometric View

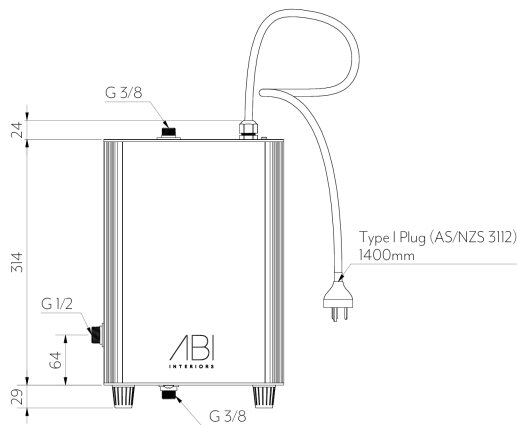

Front View

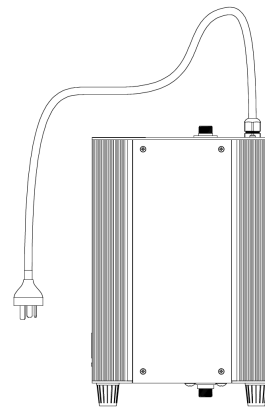

Side View

Note: Dimensions are nominal measurements only

SPECIFICATIONS

RECOMMENDED USE

Domestic/ Commercial

TEMPERATURE RATING

Adjustable between 40 - 98 degrees

PRESSURE RATING

Recommended minimum working pressure 0.5 Bar
Recommended maximum working pressure 5 Bar

RATED VOLTAGE RATED FREQUENCY

220-240V
50Hz

RATED CURRENT POWER CONSUMPTION

10A
0.89KWh per 24h

CAPACITY

3.5L

INSTALLATION GUIDE

Note: This product must be installed by a licensed plumber. This is a general installation guide - there are many factors involved that can alter the installation method. **UK:** For installations in the United Kingdom this product must be installed in compliance with the Water Supply (Water Fittings) Regulations and Water Supply (Water Fittings) (Scotland) Byelaws. **Other:** For installations outside these countries, this product must be installed in compliance with the standards in your respective country.



INSTALLATION

- 1 Once tap has been installed into bench, connect hoses to boiler as shown in diagram.
- 2 Overflow hose can be connected to existing plumbing with provided threaded metal connector.
- 3 Check that the drainage cap is installed correctly then turn on the cold water connection to the boiler. Turn boiler handle on tap and hold to fill the boiler tank. Once boiler is full water will flow from the tap. Let water flow for 5 minutes to flush boiler and filter.
- 4 Check all connections to ensure no kinks in hoses then connect to power supply.
***ENSURE BOILER TANK IS FULL OF WATER BEFORE SWITCHING ON, DAMAGE CAUSED BY NOT FOLLOWING THIS INSTRUCTION WILL VOID WARRANTY.**

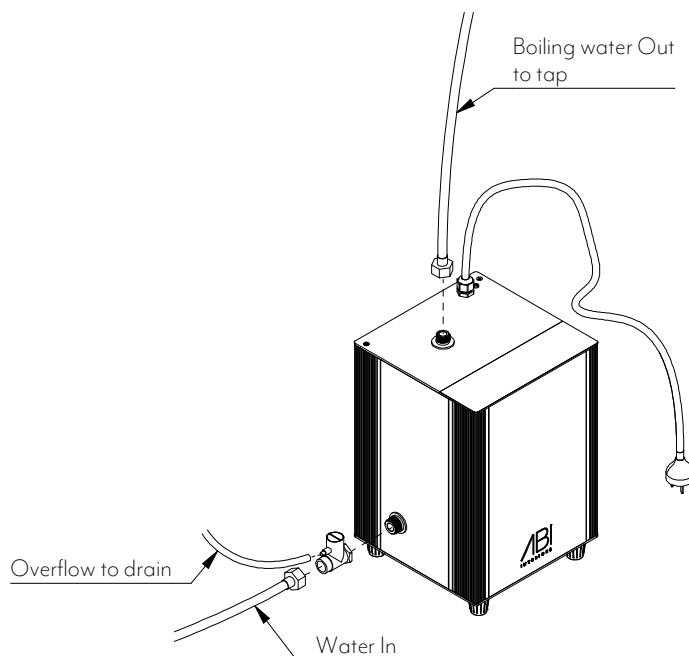

OPERATION

- Turn on boiler
- Buttons can be used to adjust temperature between 40° and 98°
- Once temperature has been selected, 'HEATING' will illuminate.
- Once temperature has been reached, 'READY' will illuminate.

SAFETY

The boiler has a temperature limiting safety switch that will activate if the boiler overheats. ***THIS CAN HAPPEN IF THE BOILER IS UNDERFILLED.**

E4 will display on the screen if the safety has activated.

- 1 Turn the power off to the boiler and wait 40mins
- 2 Use a coin or a screw driver to remove the cover on the base of the boiler.
- 3 Press button, then reinstall cover.
- 4 Ensure boiler tank is refilled before turning power back on by turning boiler handle and waiting for water to run through the spout.

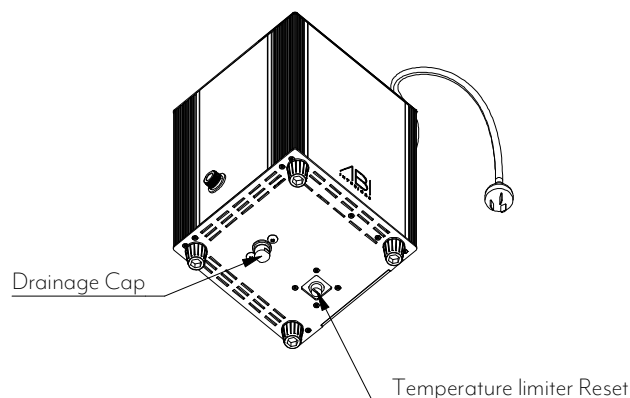

PTO for more troubleshooting options



Regularly clean with mild liquid detergent or soap and water



DO NOT use cream cleaners or bleach. These substances are abrasive

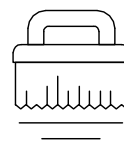

DO NOT use cleaning pads with abrasive surfaces as this may scratch the material

INSTALLATION GUIDE

Note: This product must be installed by a licensed plumber. This is a general installation guide - there are many factors involved that can alter the installation method. **UK:** For installations in the United Kingdom this product must be installed in compliance with the Water Supply (Water Fittings) Regulations and Water Supply (Water Fittings) (Scotland) Byelaws. **Other:** For installations outside these countries, this product must be installed in compliance with the standards in your respective country.



TROUBLESHOOTING		
FAULT	REASON	SOLUTION
E1 (Displayed on Boiler Screen)	Electrical short. Current over 25mA.	Disconnect from power and contact ABI aftersales service.
E2 (Displayed on Boiler Screen)	Tank heating without water inside. Temperature will rapidly rise triggering the temperature limiting safety switch.	Turn off the power. Fill the boilers tank by turning the boiler handle on the tap untill water flows through the spout. Then turn power back on.
E3 (Displayed on Boiler Screen)	Temperature sensor failure.	Disconnect from power and contact ABI aftersales service.
Water icing on tank	Anti-freeze protection failure. When the boiler is off, if the water temperature in the tank is below 4°C, the boiler will auto-start heating until the water temperature reaches 12°C.	If the Anti-freeze protection does not solve this issue, turnoff the power and ask for service from dealer.
Hot water or steam released from tap when not in use	The cartridge has malfunctioned or the autoclose feature of the handle has malfunctioned.	Contact ABI aftersales for Warranty replacement.
The water is not hot	-There is no power supply to the boiler. -The boiler is turned off. -The temperature has been set too low.	Check power supply. Check temperature setting
The flow has reduced	-Low mains water pressure. -The water filter needs to be replaced.	Check water pressure Replace filter
There is no water flow	-The water supply has been turned off. -The inlet pipes have become kinked.	Check water supply and inlet pipes.



Regularly clean with mild liquid detergent or soap and water



DO NOT use cream cleaners or bleach. These substances are abrasive

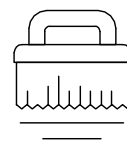

DO NOT use cleaning pads with abrasive surfaces as this may scratch the material