

Side View

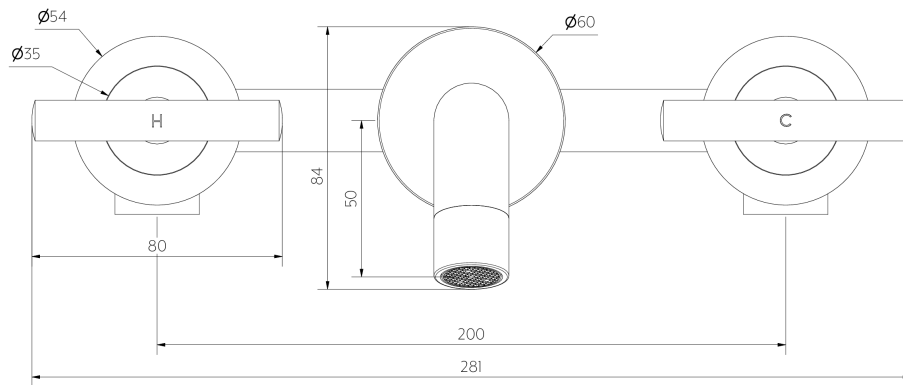

Front View

Note: Dimensions are nominal measurements only

SPECIFICATIONS

MATERIAL

Solid Brass

TEMPERATURE RATING

Maximum continuous working temperature 75°C
If the water temperature exceeds 75°C, an approved tempering valve must be fitted

PRESSURE RATING

Recommended minimum working pressure 0.2 Bar
Recommended maximum working pressure 5 Bar
Hot and cold water inlet pressure should be equal

SUITABLE HOT WATER UNITS

Storage tank: Yes
Continuous Flow: Yes
Gravity Feed: Suitable

WATER EFFICIENCY

Flow Rate 5.5L/min

PACKAGING

Includes In-wall Breech.

INSTALLATION GUIDE

Note: This product must be installed by a licensed plumber. This is a general installation guide - there are many factors involved that can alter the installation method. **AU/NZ:** For installations within Australia and New Zealand, this product must be installed in compliance with AS/NZS 3500. **UK:** For installations in the United Kingdom this product must be installed in compliance with the Water Supply (Water Fittings) Regulations and Water Supply (Water Fittings) (Scotland) Byelaws. **Other:** For installations outside these countries, this product must be installed in compliance with the standards in your respective country.

ABI
INTERIORS

1

Install the sleeve onto the locking nut and hand tighten.
Slide backplate over sleeve.

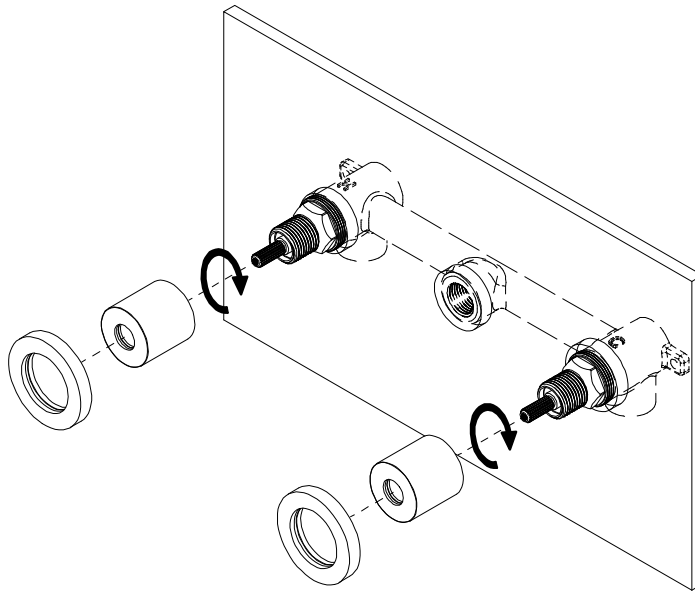

2

Install tap handle onto spindle and tighten in place using grub screw.

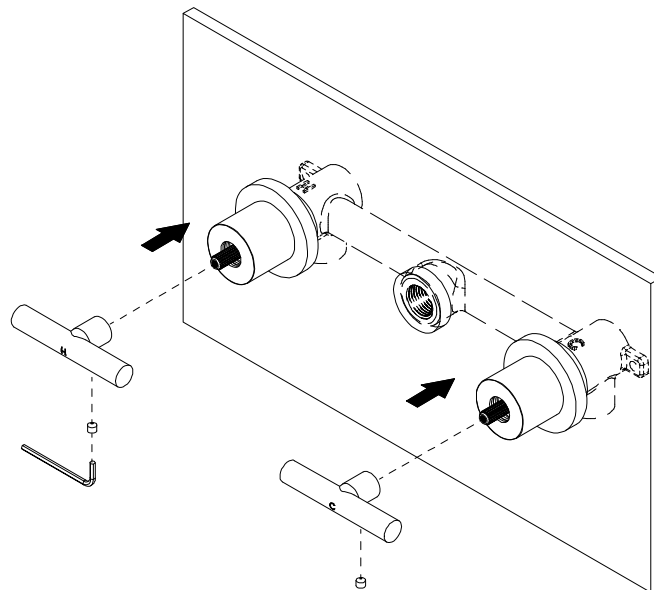

Regularly clean with mild liquid detergent or soap and water



DO NOT use cream cleaners or bleach. These substances are abrasive

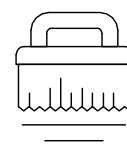

DO NOT use cleaning pads with abrasive surfaces as this may scratch the material

INSTALLATION GUIDE

Note: This product must be installed by a licensed plumber. This is a general installation guide - there are many factors involved that can alter the installation method. **AU/NZ:** For installations within Australia and New Zealand, this product must be installed in compliance with AS/NZS 3500. **UK:** For installations in the United Kingdom this product must be installed in compliance with the Water Supply (Water Fittings) Regulations and Water Supply (Water Fittings) (Scotland) Byelaws. **Other:** For installations outside these countries, this product must be installed in compliance with the standards in your respective country.



SET BACK GUIDE

Minimum Standard Spindle Setback:

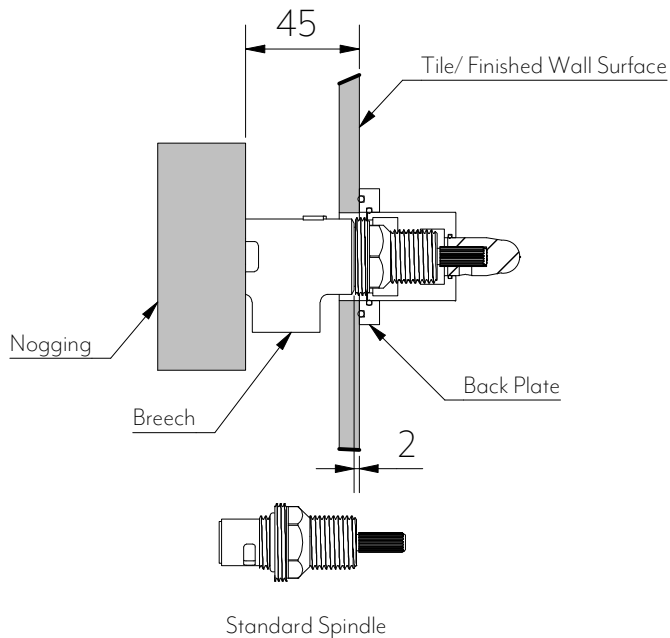

Minimum distance between nogging and finished wall surface is 45mm (or 2mm from in-wall breach to finished wall surface).

Maximum Standard Spindle Setback:

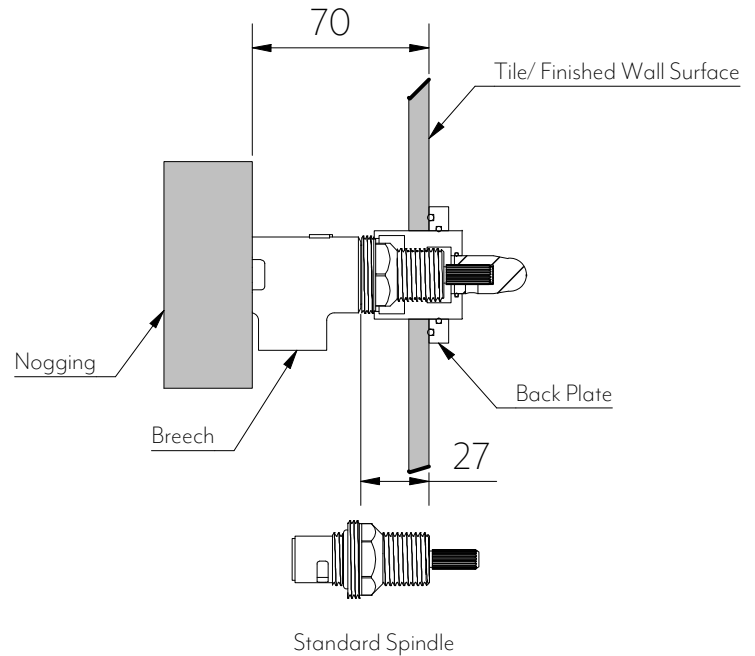

Maximum distance that can be achieved using a standard spindle between finished wall surface and nogging is 70 mm (or 27 mm from in-wall breach to finished wall surface).

Minimum Extended Spindle Setback:

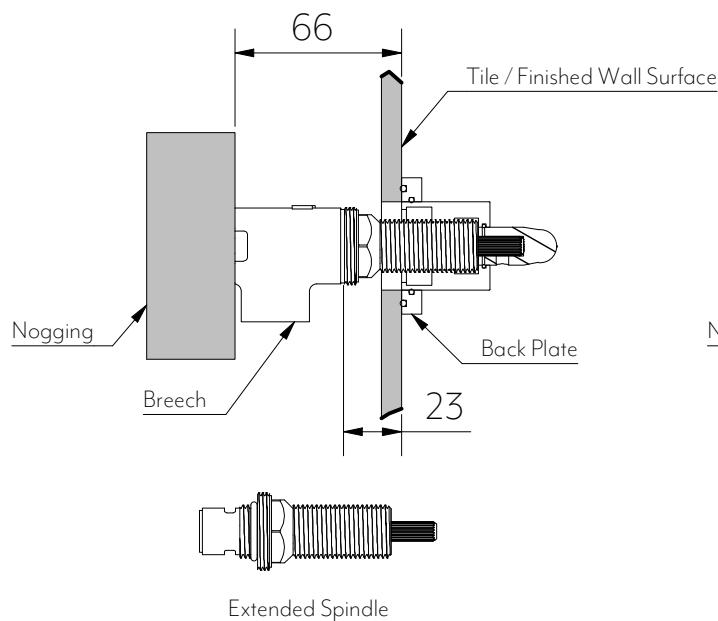

For installations when distance between nogging and finished wall surface is 66mm (or 23mm from in wall breach to finished wall surface), an extended spindle is required (available for additional purchase).

Maximum Extended Spindle Setback:

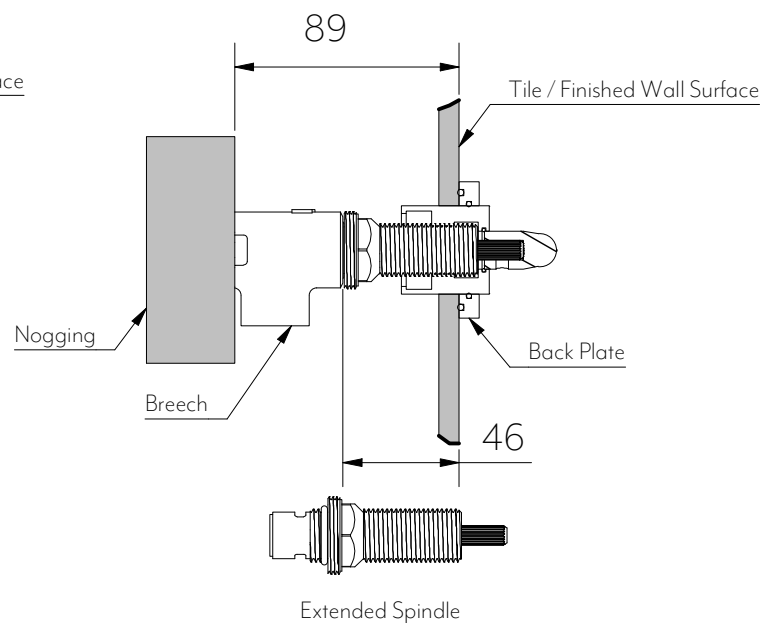

The maximum distance this assembly can achieve using an extended spindle from nogging to finished wall surface is 89mm, (or 46mm from in-wall breach to finished wall surface).

Note: ABI offers additional parts for non-standard installs. Contact our sales team if you need assistance.

INSTALLATION GUIDE

Note: This product must be installed by a licensed plumber. This is a general installation guide - there are many factors involved that can alter the installation method. **AU/NZ:** For installations within Australia and New Zealand, this product must be installed in compliance with AS/NZS 3500. **UK:** For installations in the United Kingdom this product must be installed in compliance with the Water Supply (Water Fittings) Regulations and Water Supply (Water Fittings) (Scotland) Byelaws. **Other:** For installations outside these countries, this product must be installed in compliance with the standards in your respective country.



ASSEMBLY SETUP GUIDE

Example One:
Off-set basin mixer/ bath spout set-up

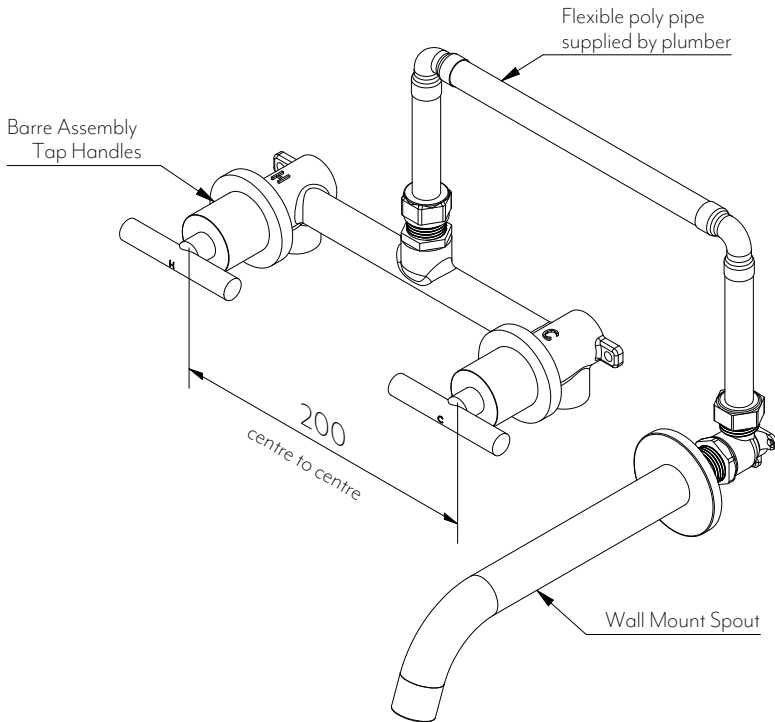

Example Two:
Centred basin mixer/ bath spout set-up

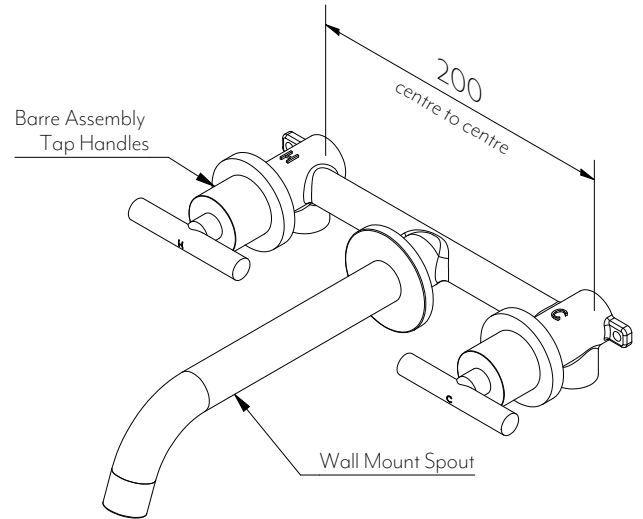

Example Three:
Shower set-up

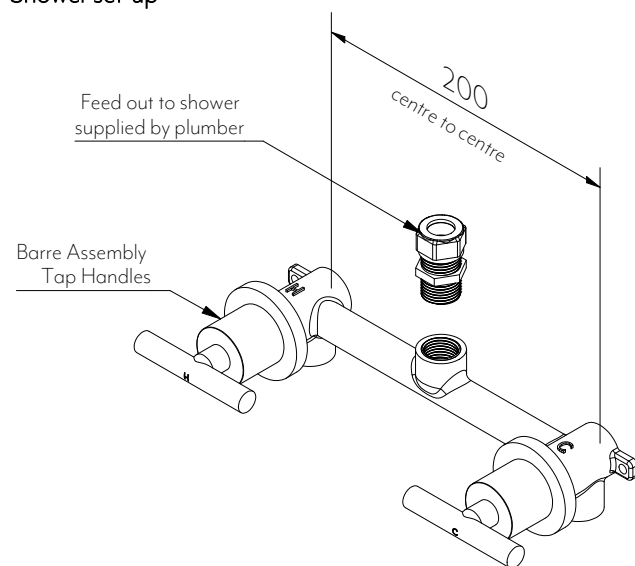

Note: In-line plumbing breech available for purchase from ABI

In The Box	
2 x Handle	
2 x Sleeve	
2 x Back plate	
2 x Grub screw	
1 x Allen key	

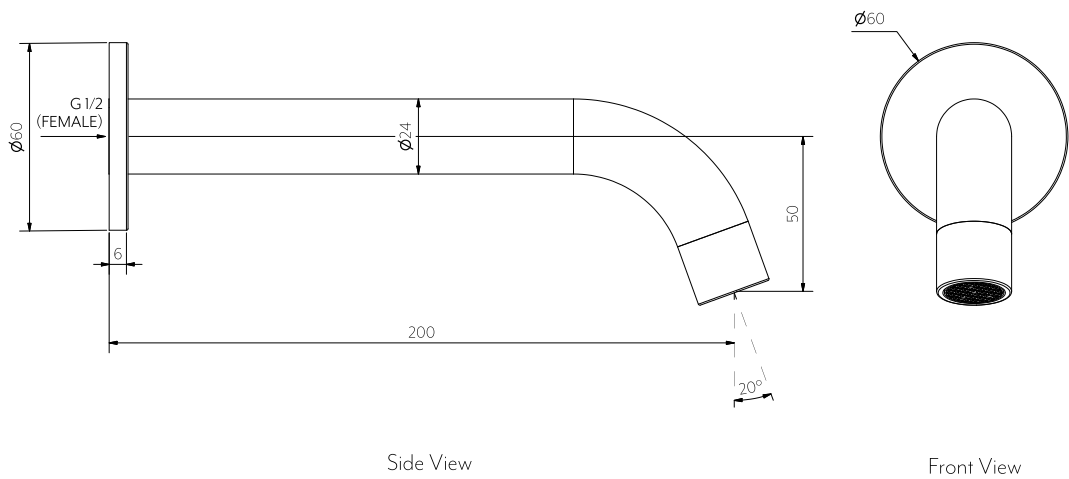

Note: Dimensions are nominal measurements only

SPECIFICATIONS

RECOMMENDED USE	Domestic
MATERIAL	Solid Brass
TEMPERATURE RATING	Maximum continuous working temperature 75°C If the water temperature exceeds 75°C,an approved tempering valve must be fitted
PRESSURE RATING	Recommended minimum working pressure 0.2 Bar Recommended maximum working pressure 5 Bar Hot and cold water inlet pressure should be equal
SUITABLE HOT WATER UNITS	Storage tank: Yes Continuous Flow: Yes Gravity Feed: Suitable
WATER EFFICIENCY	Flow Rate 5.5L/min

INSTALLATION GUIDE





Note: This product must be installed by a licensed plumber. This is a general installation guide - there are many factors involved that can alter the installation method. **AU/NZ:** For installations within Australia and New Zealand, this product must be installed in compliance with AS/NZS 3500. **UK:** For installations in the United Kingdom this product must be installed in compliance with the Water Supply (Water Fittings) Regulations and Water Supply (Water Fittings) (Scotland) Byelaws. **Other:** For installations outside these countries, this product must be installed in compliance with the standards in your respective country.

- ① Slide the back plate onto the spout, make sure that the rubber is firmly in place to protect the spout and stop the back plate from moving around.

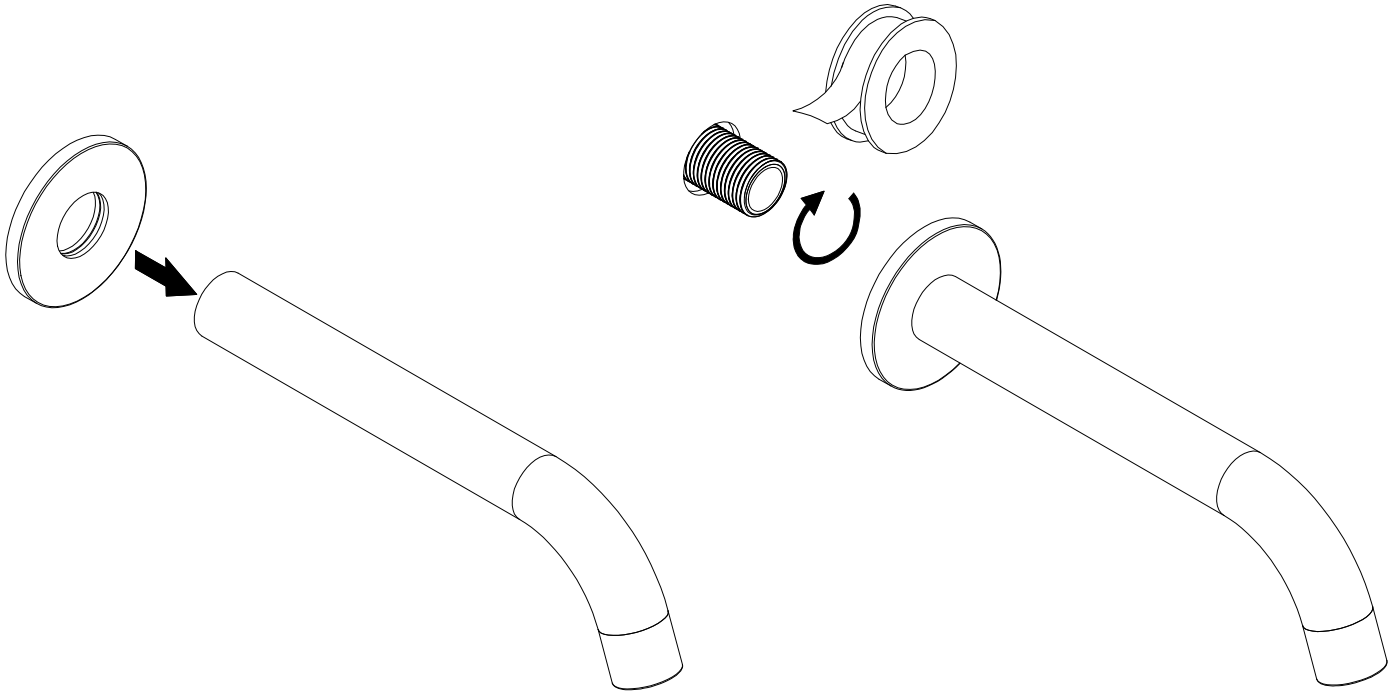
- ② Apply teflon thread tape to the breech point, twist the spout on and hand tighten.

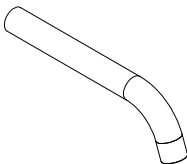

IN THE BOX		
		
1 x Back Plate	1 x Spout	1 x Adaptor



Regularly clean with mild liquid detergent or soap and water



DO NOT use cream cleaners or bleach. These substances are abrasive

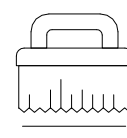

DO NOT use cleaning pads with abrasive surfaces as this may scratch the material

1/2 INCH MALE ADAPTOR INSTALLATION GUIDE



Note: This product must be installed by a licensed tradesperson.
This is a general installation guide - there are many factors that are involved that can alter the installation method.

① Apply teflon tape to 1/2 inch male adaptor.

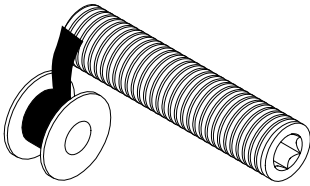

② Fit 1/2 inch male adaptor to female BP and tighten with a 12 mm metric Allan key.

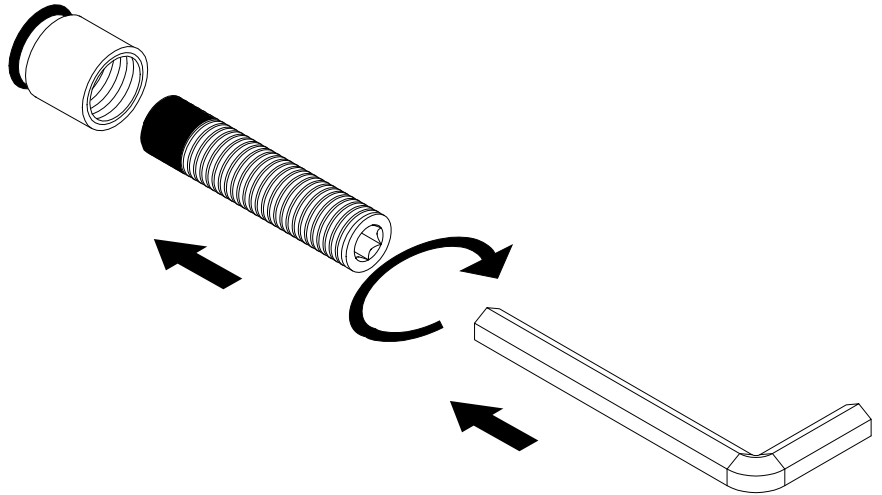

③ Cut 1/2 inch male adaptor to suit wall thickness and product.

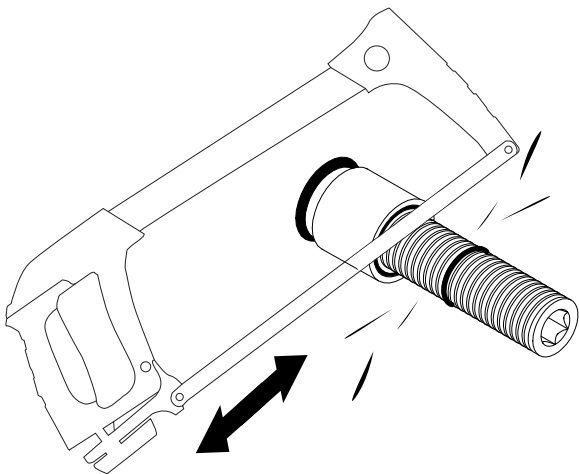

A **TMV** [Thermostatic Mixing Valve] is required in homes that do not have a TMV fitted, If the hot water coming out your tap is more than **50°C** you will need to adjust your TMV.

1. We recommend placing your **TMV** directly after your hot water/ boiler unit. Consult with a **licensed plumber** to discuss the best position for your needs.

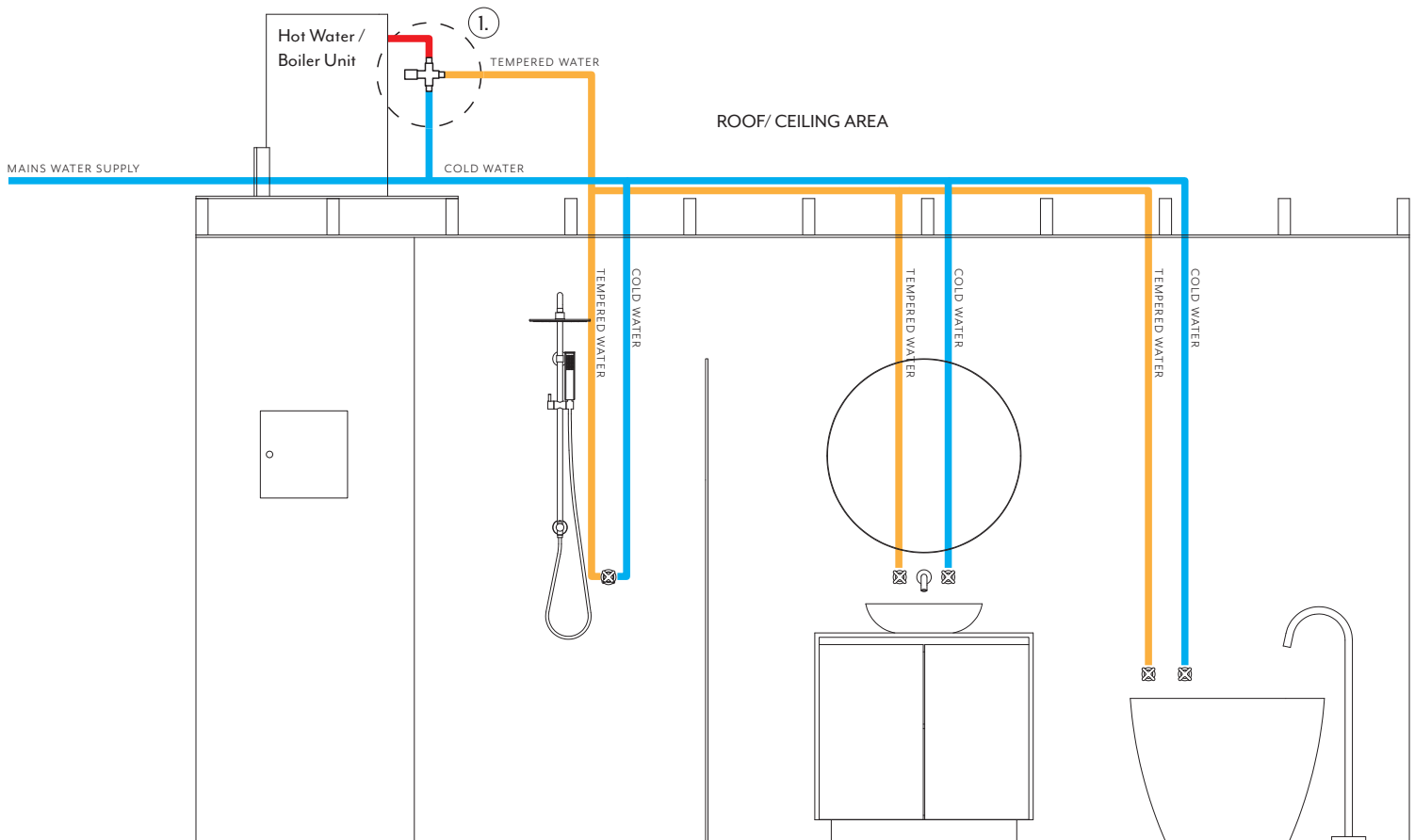

— TEMPERED WATER — COLD WATER — SCOLDING WATER

1. Directly after your hot water unit
2. Inside a service panel
3. Inside a service panel behind removable mirror
4. Inside the bathroom vanity unit

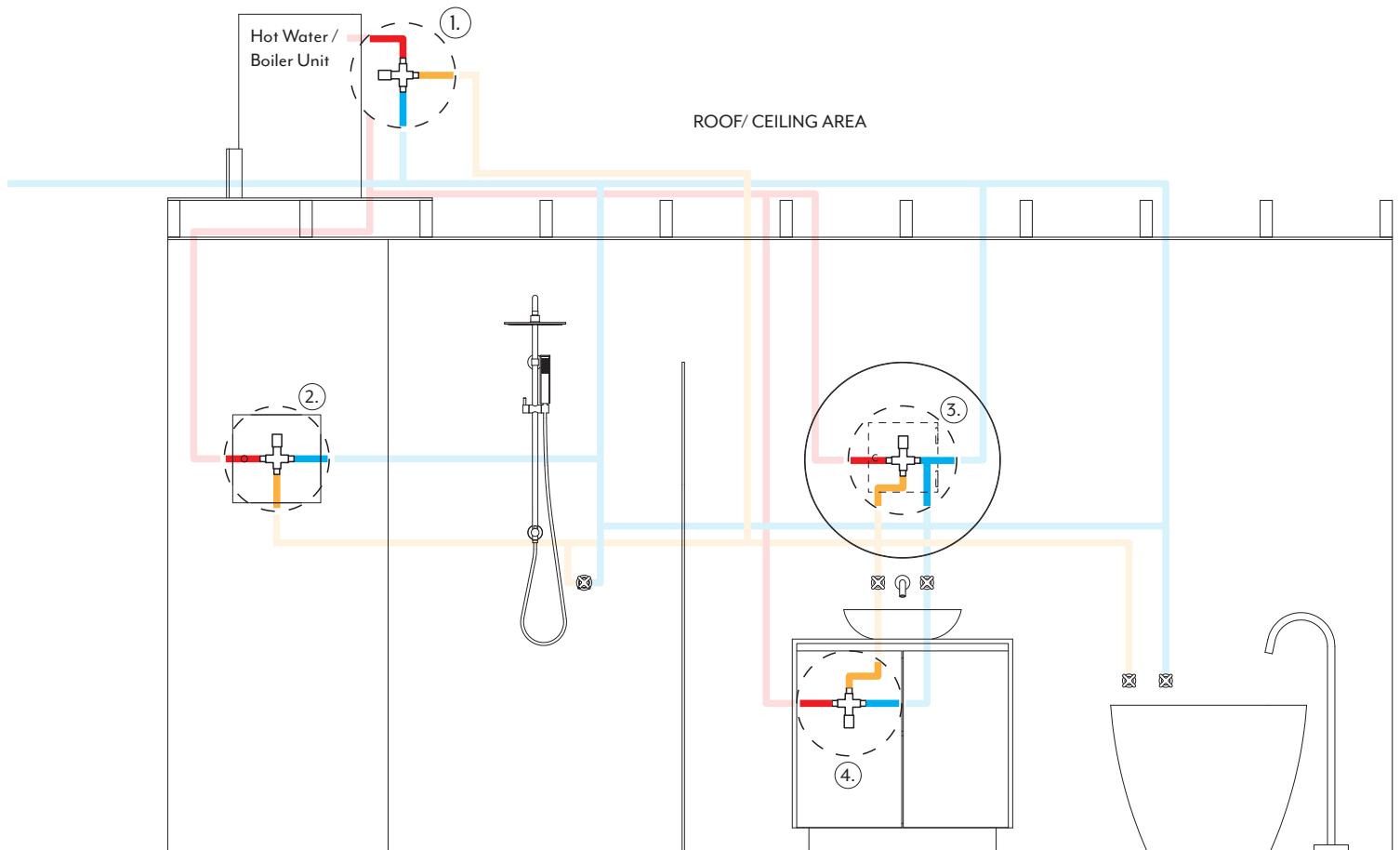

— TEMPERED WATER
 — COLD WATER
 — SCOLDING WATER