

**Note:** Dimensions are nominal measurements only

## SPECIFICATIONS

MATERIAL

304 Stainless Steel

FUNCTION

Pull or Slide

# INSTALLATION GUIDE

This product must be installed by a licensed tradesperson.

This is a general installation guide - there are many factors that are involved that can alter the installation method. This product install must comply with the standards in your respective country and must be adhered to by your licensed tradesperson.



- 1 Measure the desired height that you wish for the flush pull to sit at and mark a fixed point.  
Mark the required circumference of the flush pull from its rear box (this is the back section of the flush pull).

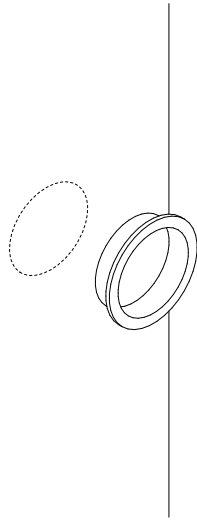

- 2 Use a multi tool or preferred method to evenly remove material to the correct depth.  
Apply the necessary amount of adhesive as required to the cut surface.

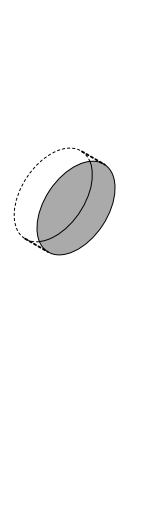

- 3 Press the flush pull into the cavity.

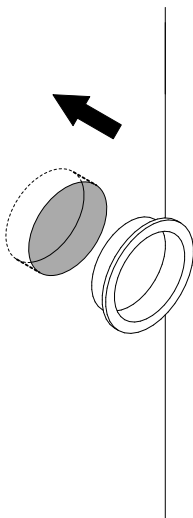

- 4 Use fixings provided to secure flush pull into position

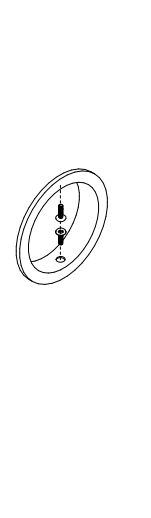

Regularly clean with mild liquid detergent or soap and water.



DO NOT use cream cleaners or bleach. These substances are abrasive.



DO NOT use cleaning pads with abrasive surfaces as this may scratch the material.