

SIDE VIEW

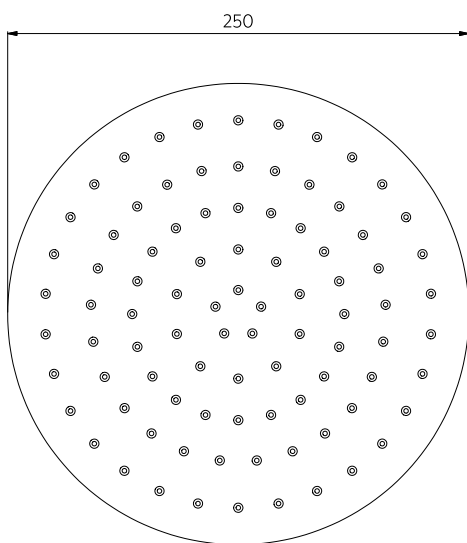

BOTTOM VIEW

Note: Dimensions are nominal measurements only

SPECIFICATIONS

RECOMMENDED USE

Domestic

MATERIAL

316 Stainless Steel

TEMPERATURE RATING

Maximum continuous working temperature 75°C
If the water temperature exceeds 75°C, an approved tempering valve must be fitted

PRESSURE RATING

Recommended minimum working pressure 150kPa
Recommended maximum working pressure 500kPa
Hot and cold water inlet pressure should be equal

SUITABLE HOT WATER UNITS

Storage tank: Yes
Continuous Flow: Yes
Gravity Feed: Not suitable

STANDARDS

WELS 3 Star, 8L/min, S16410

INSTALLATION GUIDE

Note: This product must be installed by a licensed plumber.
This is a general installation guide - there are many factors that are involved that can alter the installation method.
This product install must comply with AS/NZS 3500.



- 1 Ensure o-ring is fitted inside the ball joint connector.

- 2 Fasten ball joint and shower head to arm with spanner using a cloth to ensure not to damage finish.

Note: Shower arm and back plate not included.

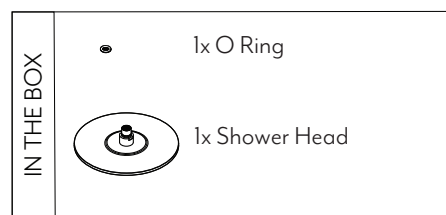
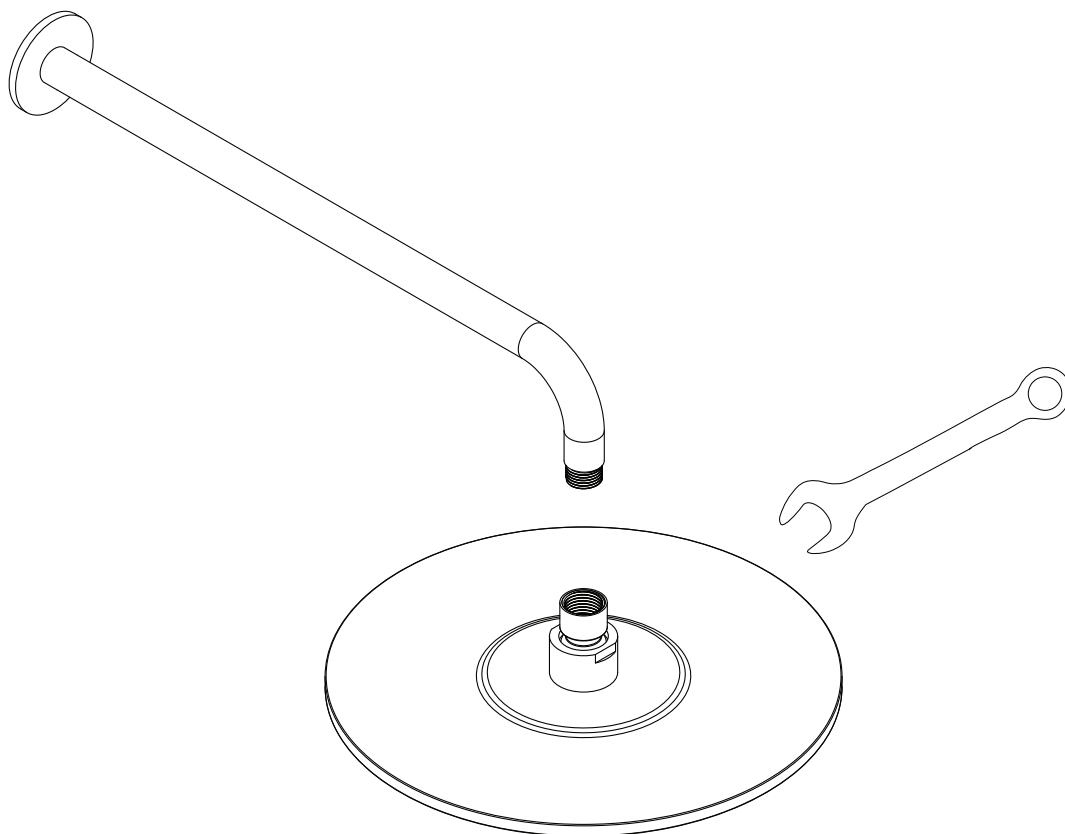

Regularly clean with mild liquid detergent or soap and water



DO NOT use cream cleaners or bleach
These substances are abrasive



DO NOT use cleaning pads with abrasive surfaces as this may scratch the material