

Front View

Side View

**Note:** Dimensions are nominal measurements only

## SPECIFICATIONS

### RECOMMENDED USE

Domestic / Commercial

### MATERIAL

316 Stainless Steel

# INSTALLATION GUIDE

**Note:** This product must be installed by a licensed plumber. This is a general installation guide - there are many factors involved that can alter the installation method. **AU/NZ:** For installations within Australia and New Zealand, this product must be installed in compliance with AS/NZS 3500. **UK:** For installations in the United Kingdom this product must be installed in compliance with the Water Supply (Water Fittings) Regulations and Water Supply (Water Fittings) (Scotland) Byelaws. **Other:** For installations outside these countries, this product must be installed in compliance with the standards in your respective country.

**ABI**  
INTERIORS

Please refer to IN-WALL MINIMAL DIVERTER MIXER BODY - 304 SS install guide & SOLA - MINIMAL HANDLE KIT install guide for initial steps.

- ① Screw sleeve onto diverter nut.
- ② Insert plastic spacer into sleeve, slide diverter back plate over sleeve, then push handle onto the end of the diverter.

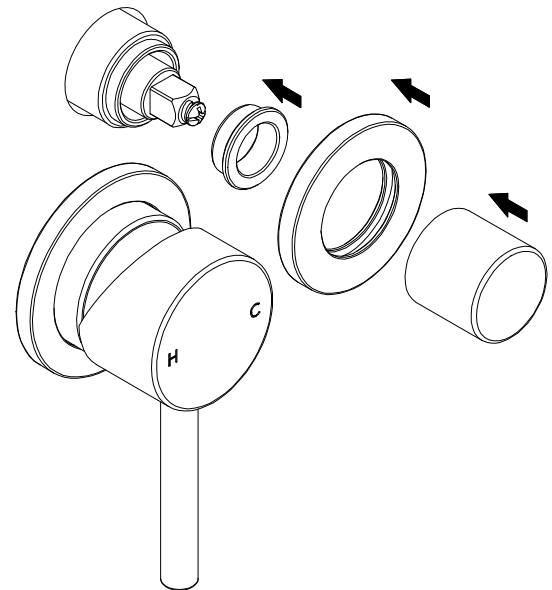
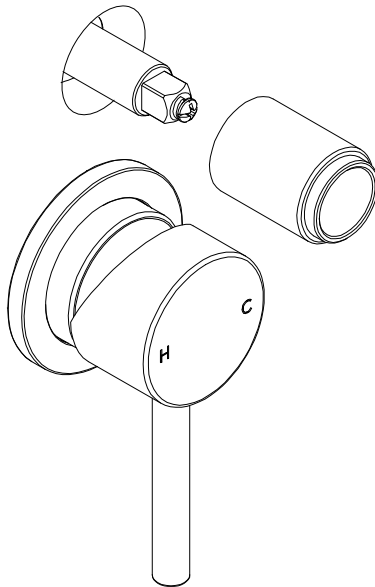



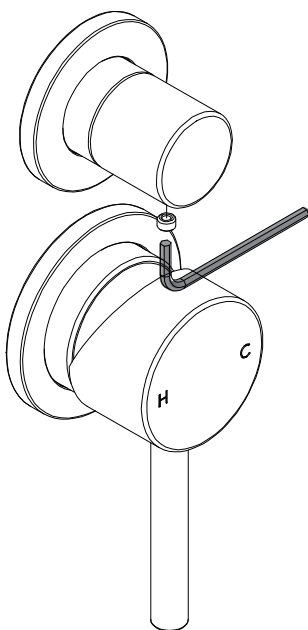

- ③ Screw grub screw into handle with provided Allen Key.

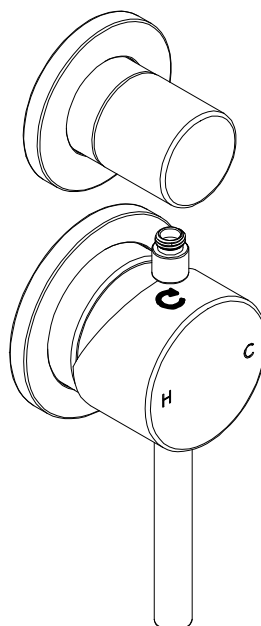

- ④ Screw diverter stick onto handle. Test and commission



In The Box	
1 x Back diverter plate	
1 x Diverter sleeve	
1 x Plastic spacer	
1 x Diverter handle	
1 x Diverter stick	



Regularly clean with mild liquid detergent or soap and water



DO NOT use cream cleaners or bleach. These substances are abrasive

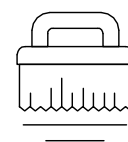

DO NOT use cleaning pads with abrasive surfaces as this may scratch the material