

SAANTI HANDMADE DOUBLE TRIM LED MIRROR 600/800MM

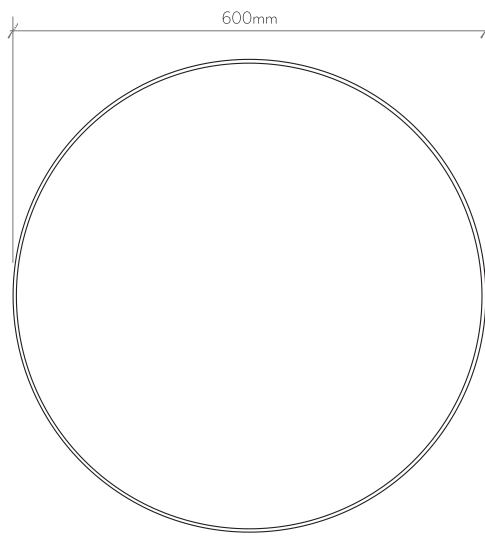

Front View

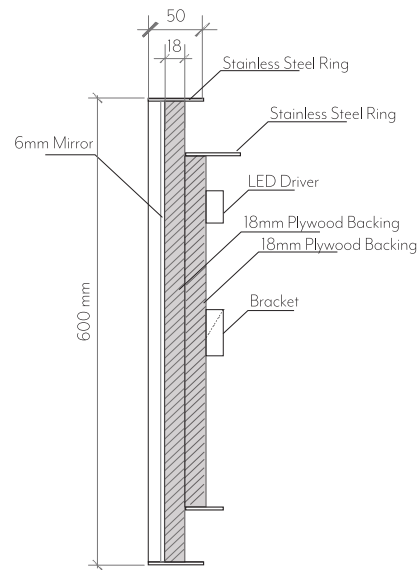

Side View

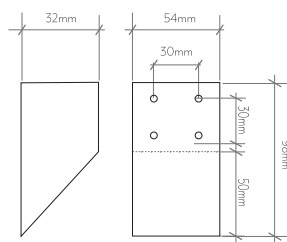

MALE BRACKET

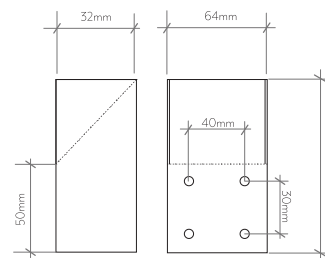

FEMALE BRACKET

Note: Dimensions are nominal measurements only

SPECIFICATIONS

RECOMMENDED USE

Domestic

MATERIAL

Stainless Steel
Plywood
Glass Mirror

LED

Yes | Hardwired
24V | 4000k
CE Certified

TRANSFORMER

Yes | Hardwired
IP Rating | IP66
60 W

MOUNTING HARDWARE

Included

INSTALLATION GUIDE

Note: This product must be installed by a licensed tradesperson.

This is a general installation guide - there are many factors that are involved that can alter the installation method.

This product install must comply with the standards in your respective country and must be adhered to by your licensed tradesperson.

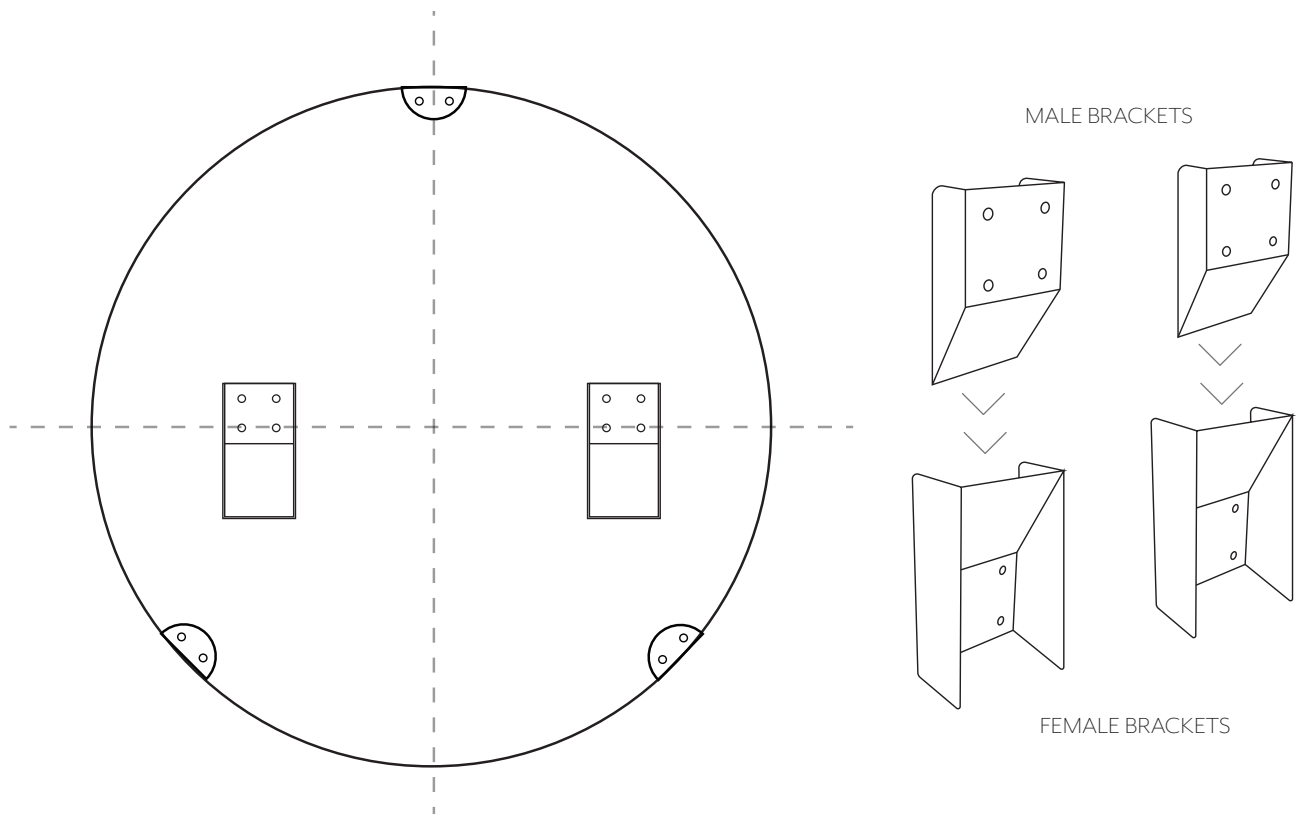

Step 1: Find a structural member within the wall being mounted to (timber stud, concrete wall, timber block)

Step 2: Install the female brackets onto the wall spread evenly to balance the mirrors weight, screws should be a minimum of 10 gauge to ensure shear strength, ensure that the screw is installed tightly and has penetrated a structural material.

Step 3: Check that the brackets are installed level with each other

Step 4: Install the male brackets onto the mirror and ensure that the location of the female and male brackets align perfectly. Ensure you do not use screws too long when fixing the male brackets as this could penetrate the mirror. We recommend using 12mm timber screws

Step 5: Engage a qualified electrician to wire into the driver which is located and pre-fitted into the back of the mirror

Step 6: Once wired, it can be mounted by lifting the mirror whilst aligning the male and female brackets, this does not require glue if brackets are installed correctly.



Regularly clean with mild liquid detergent or soap and water.



DO NOT use cream cleaners or bleach. These substances are abrasive.



DO NOT use cleaning pads with abrasive surfaces as this may scratch the material.