

PIXI TILE INSERT SHOWER CHANNEL WASTE 900MM

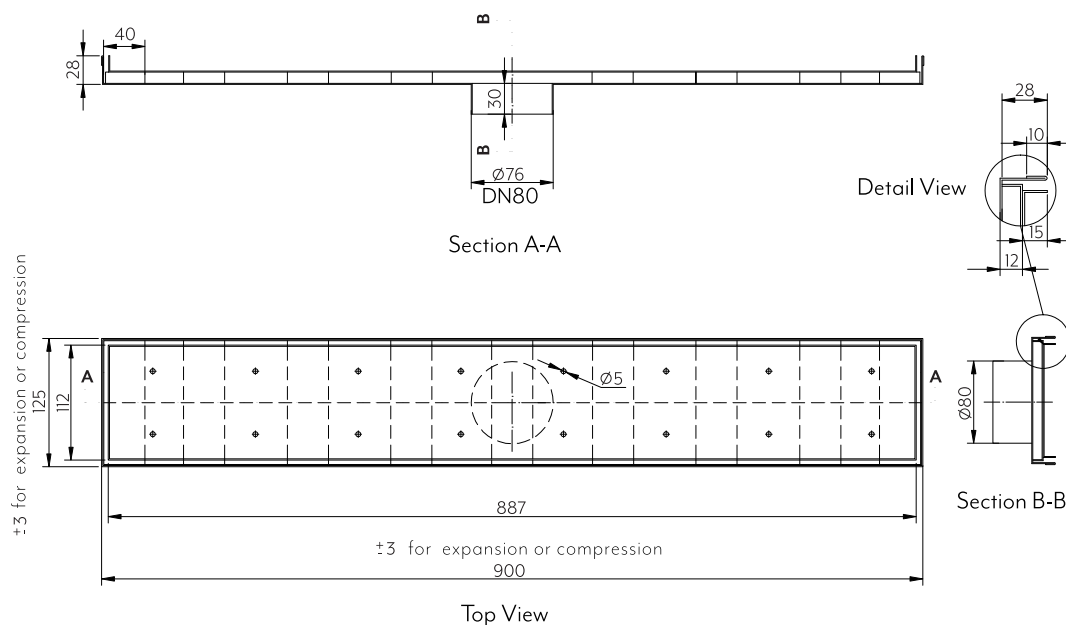

Note: Dimensions are nominal measurements only

SPECIFICATIONS

RECOMMENDED USE

Domestic/Commercial

MATERIAL

Stainless Steel

INSTALLATION

Suitable for 80mm PVC Pipe

INSTALLATION GUIDE

Note: This product must be installed by a licensed plumber. This is a general installation guide - there are many factors that are involved that can alter the installation method. The standards in your respective country must be adhered to by your licensed tradesperson.



Installation and preparation of shower or bathroom floor as per AS3500 and AS3740.

- 1 Note: The same installation principle applies to either a concrete or timber floor construction.

Allow a recess in the floor at pipe location to accommodate puddle flange, which is siliconed & screwed into position.

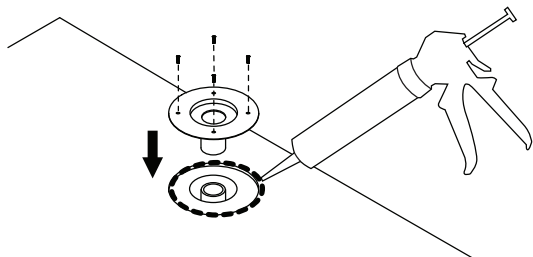

- 3 Adjust the top of the puddle flange to the finished height required for the shower grate installation.

Note: Remove puddle flange decal prior to showergrate installation.

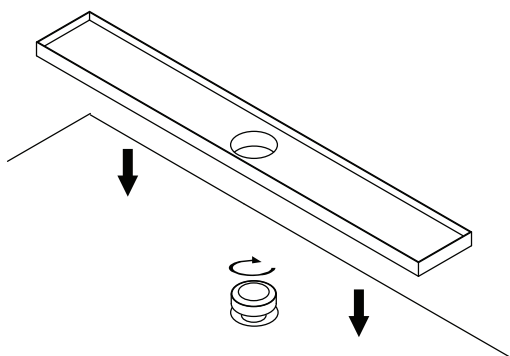

- 2 After walls & floors are lined & stopjoints are installed, the waterproofing can be applied both on to and in to the puddle flange.

Once waterproofing has adequately set, screw the puddle flange center back into place.

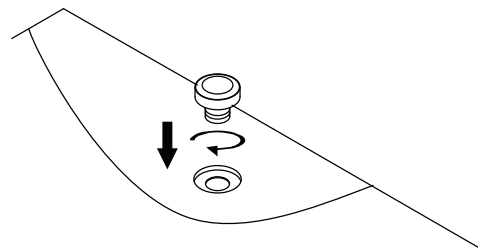

- 4 Bedding is applied around & underneath the grate. Level around the perimeter of the grate with any excess bedding being scraped away to allow for tile and silicone thickness, so the finished tile height is just above the finished height of the shower grate

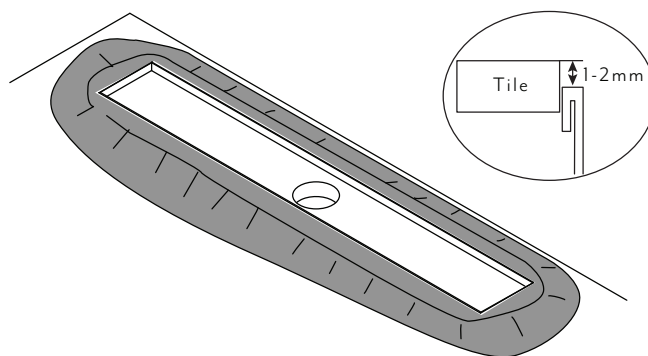

- 5 The remainder of the sand cement is installed to allow for correct falls down to the drain. Test fall levels prior to tiling in accordance with you local building standards.

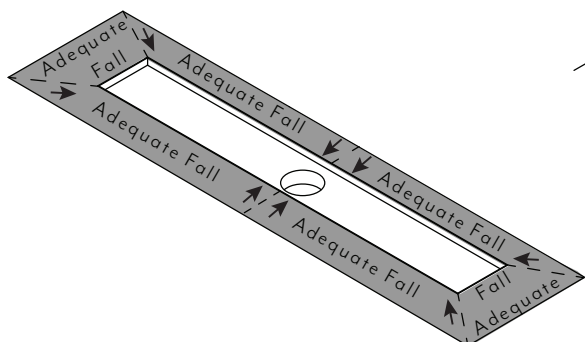

- 6 Lay tiles into insert tray and fit tray into base.

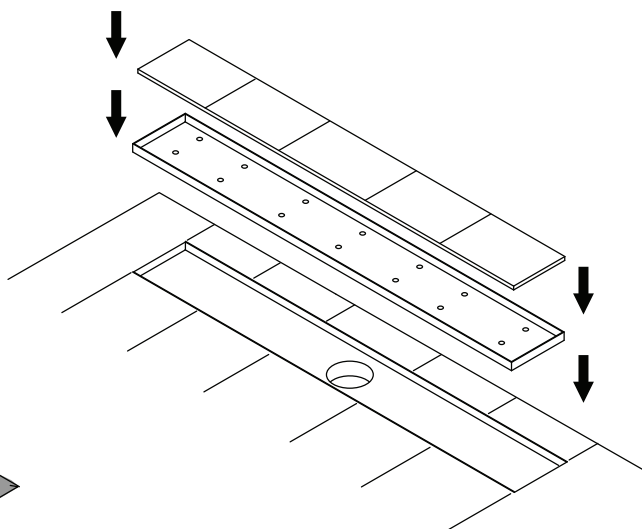

EXPLODED INSTALL VIEW



Note: This product must be installed by a licensed plumber. This is a general installation guide - there are many factors that are involved that can alter the installation method. The standards in your respective country must be adhered to by your licensed tradesperson.

Installation and preparation of shower or bathroom floor as per AS3500 and AS3740.

Model Numbers

- 10461 Pixi Shower Channel Smart Waste - 900mm - Brushed Copper
- 10462 Pixi Shower Channel Smart Waste - 900mm - Brushed Brass
- 10463 Pixi Shower Channel Smart Waste - 900mm - Stainless Steel
- 11572 Pixi Shower Channel Smart Waste - 900mm - Brushed Gunmetal

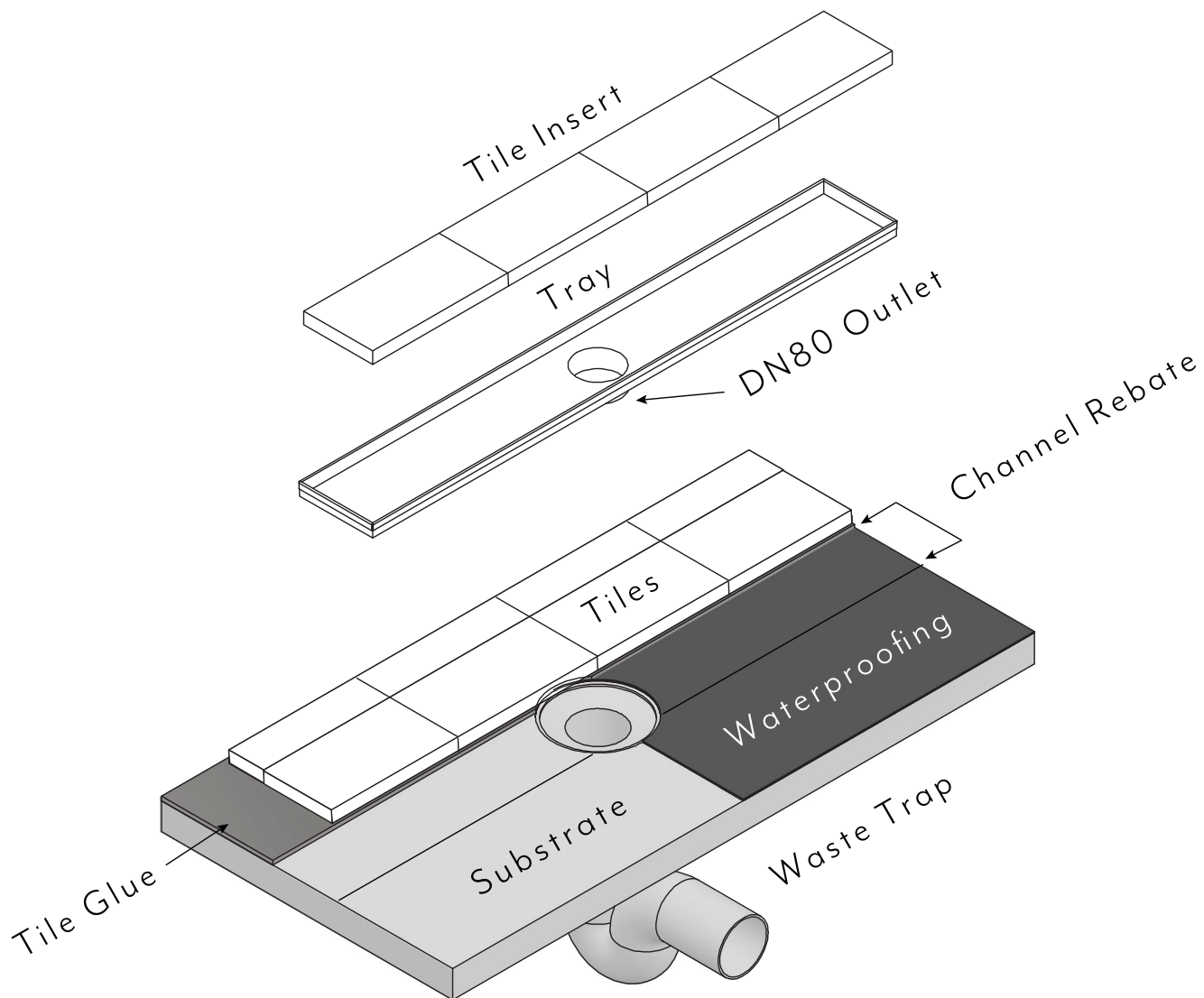

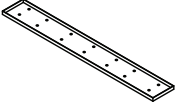
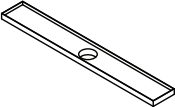
IN THE BOX		1x Shower grate top
		1x Shower grate