

Top View

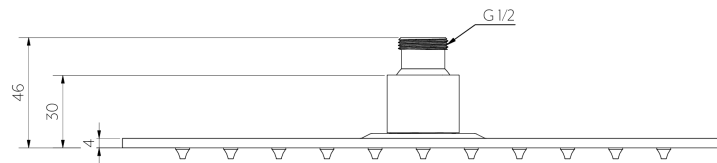

Front View

Note: Dimensions are nominal measurements only



SPECIFICATIONS

RECOMMENDED USE

Domestic / Commercial | [Click here for warranty periods](#)

MATERIAL

Stainless Steel 304

TEMPERATURE RATING

Maximum continuous working temperature 75°C
If the water temperature exceeds 75°C, an approved tempering valve must be fitted

PRESSURE RATING

Recommended minimum working pressure 150kPa
Recommended maximum working pressure 500kPa
Hot and cold water inlet pressure should be equal

SUITABLE HOT WATER UNITS

Storage tank: Yes
Continuous Flow: Yes
Gravity Feed: Not suitable

INSTALLATION GUIDE

Note: This product must be installed by a licensed plumber. This is a general installation guide - there are many factors involved that can alter the installation method. **AU/NZ:** For installations within Australia and New Zealand, this product must be installed in compliance with AS/NZS 3500. **UK:** For installations in the United Kingdom this product must be installed in compliance with the Water Supply (Water Fittings) Regulations and Water Supply (Water Fittings) (Scotland) Byelaws. **Other:** For installations outside these countries, this product must be installed in compliance with the standards in your respective country.

ABI
INTERIORS

- ① Nesso shower head has been designed to be used with Nesso shower dropper & Nesso shower arm.
*Please note shower arm/dropper not included.
Shown for installation purposes only.

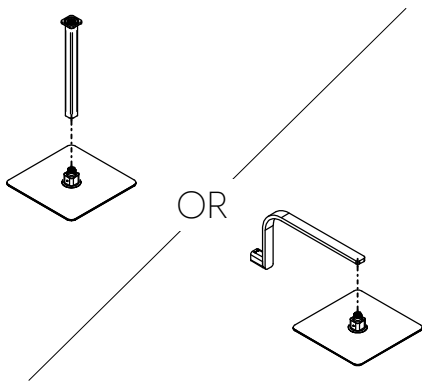

- ② Remove grub screw and unscrew swivel connection from shower head.

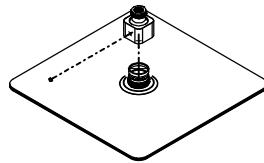

- ③ Install swivel connection into shower rail or dropper using 8mm Allen key.
*ensuring rubber o-ring (1) goes in first and flow controller (2) is carefully recessed into swivel connection to avoid damage from threads.

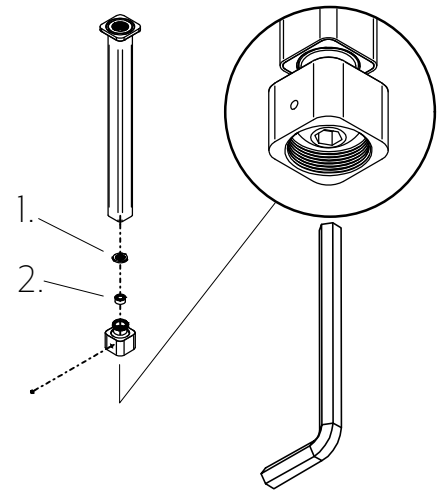

- ④ Screw shower head to the swivel connection, ensuring plastic slip collar is recessed into shower head.

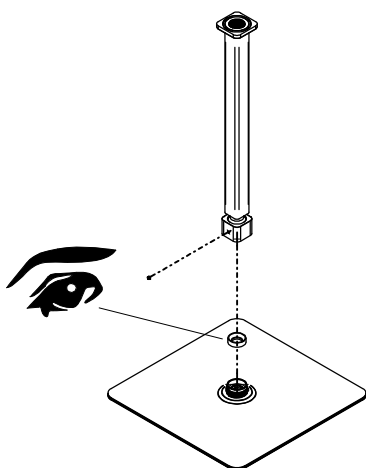

- ⑤ Hand tighten until connection is square with shower head.
Tighten grub screw to fix in place.

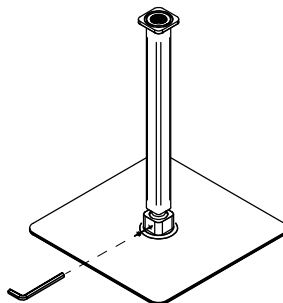

IN THE BOX

1 x Shower head



1 x Allen key



Regularly clean with mild liquid detergent or soap and water



DO NOT use cream cleaners or bleach. These substances are abrasive

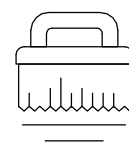

DO NOT use cleaning pads with abrasive surfaces as this may scratch the material