

OPERATION

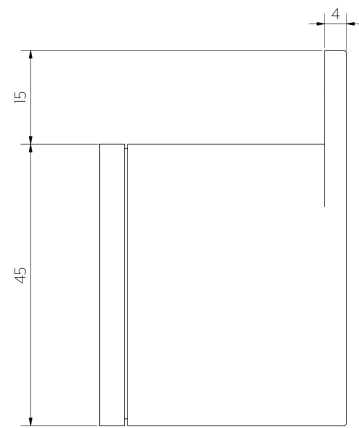

Side View

Top View

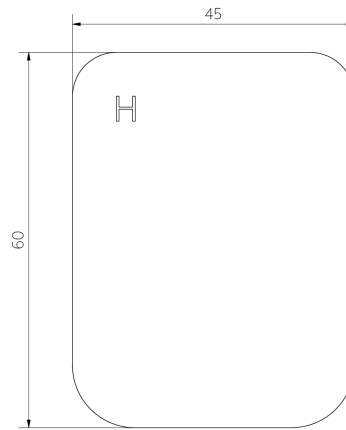

Front View

Note: Dimensions are nominal measurements only

SPECIFICATIONS

RECOMMENDED USE

Domestic / Commercial

MATERIAL

Stainless Steel 304

INSTALLATION GUIDE

Note: This product must be installed by a licensed plumber. This is a general installation guide - there are many factors involved that can alter the installation method. **AU/NZ:** For installations within Australia and New Zealand, this product must be installed in compliance with AS/NZS 3500. **UK:** For installations in the United Kingdom this product must be installed in compliance with the Water Supply (Water Fittings) Regulations and Water Supply (Water Fittings) (Scotland) Byelaws. **Other:** For installations outside these countries, this product must be installed in compliance with the standards in your respective country.



FIT-OFF

See rough-in guides for in-wall component installation.

- ① Screw sleeves over exposed threads of each spindle.

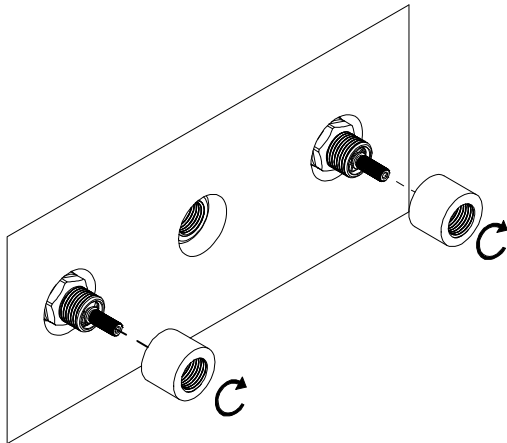

- ② Slide backplate over sleeve ensuring not to scratch.

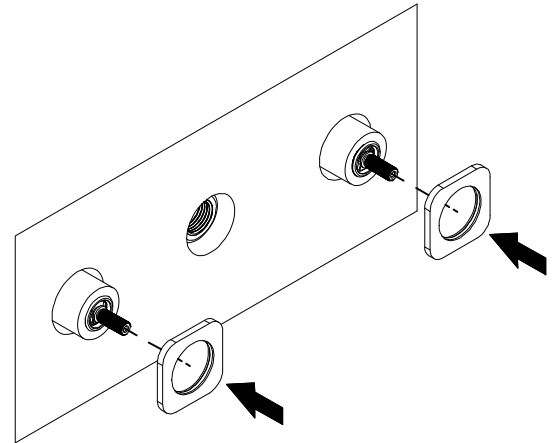

- ③ Install handle onto spindle by tightening grub screw with provided Allen key.
Insert grub screw cap.
Note: Ensure plastic collar is correctly recessed into handle.

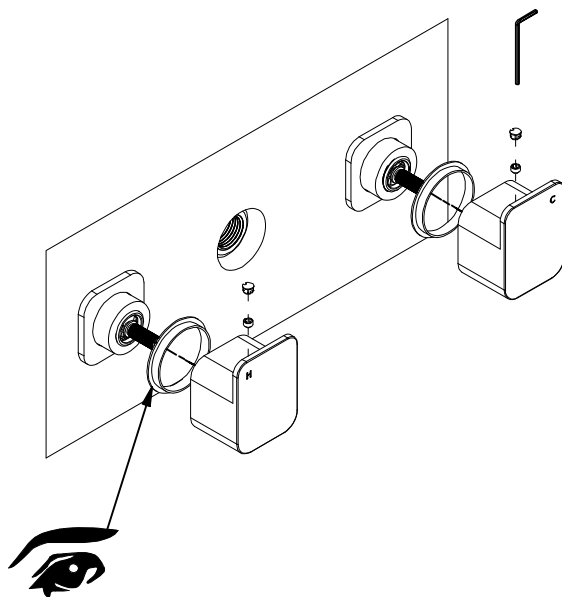

WHAT'S IN THE BOX (handle kit)

2 x Handle

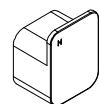

2 x Backplate



2 x Plastic collar



2 x Sleeve



2 x Grub screw cover



2 x Grub screw



1 x Allen key



Regularly clean with mild liquid detergent or soap and water



DO NOT use cream cleaners or bleach. These substances are abrasive

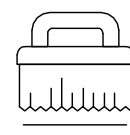

DO NOT use cleaning pads with abrasive surfaces as this may scratch the material