

**Note:** Dimensions are nominal measurements only

## SPECIFICATIONS

### RECOMMENDED USE

Domestic

### MATERIAL

Brass

### ADJUSTABLE

Yes

# INSTALLATION GUIDE

Note: This product must be installed by a licensed plumber. This is a general installation guide - there are many factors that are involved that can alter the installation method. The standards in your respective country must be adhered to by your licensed tradesperson



- 1 Attach bottle trap to pop up thread.  
**Note:** Use adaptor for 32mm thread.

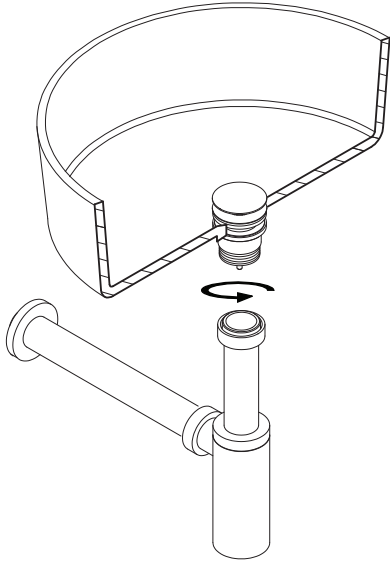

- 2 Adjust inlet pipe to suit waste.  
**Note:** Allow for fall.

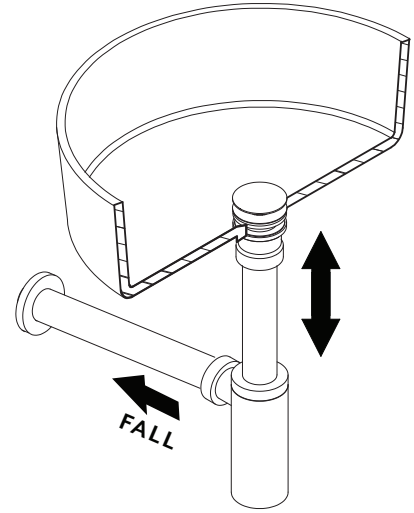

- 3 Cut waste pipe to suit.

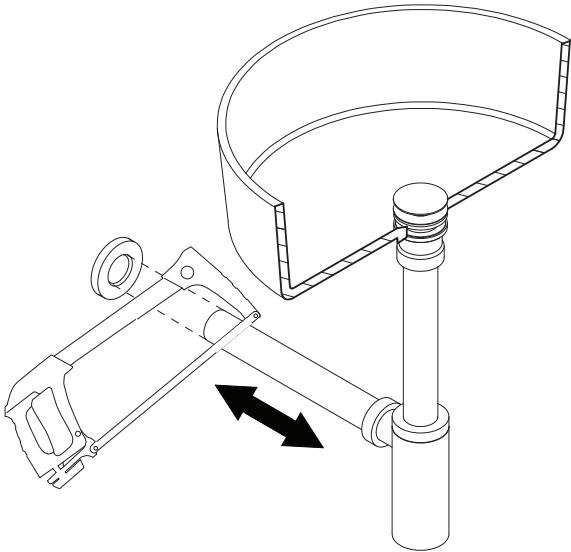

- 4 Engage kee seal into 40mm socket.

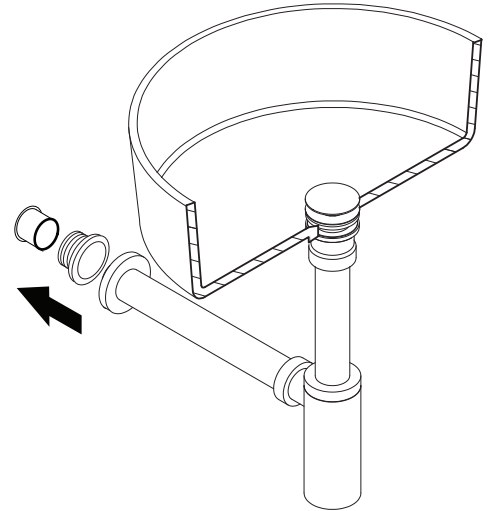

- 5 Assemble trap and tighten all components.  
Test for leakage.

