

HENLEY DOUBLE FLUTED FARMHOUSE SINK

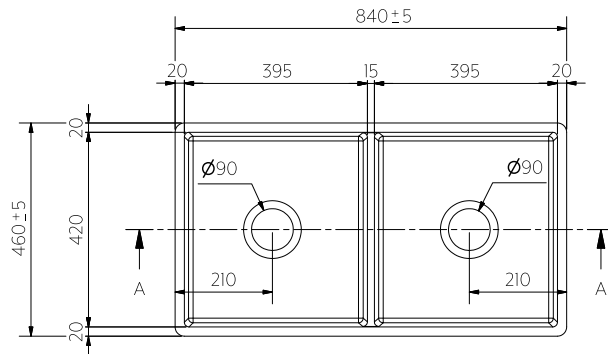

Top View

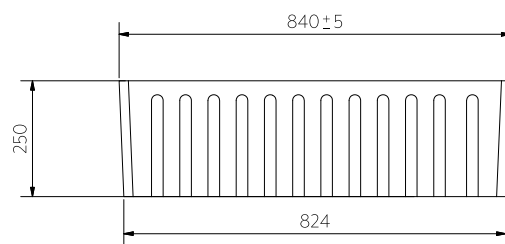

Front View

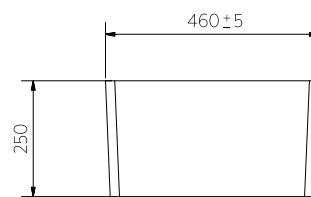

Side View

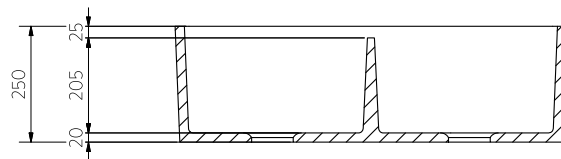

Section A-A

Note: Dimensions are nominal measurements only

SPECIFICATIONS

RECOMMENDED USE

Domestic/Commercial

MATERIAL

Ceramic

INSTALLATION

Undermount/ Flushmount

OVERFLOW

No

CAPACITY

58L

WEIGHT

43.8 kg

INSTALLATION GUIDE

This product must be installed by a licensed plumber.
This is a general installation guide - there are many factors that are involved that can alter the installation method.
This product install must comply with AS/NZS 3500.



UNDERMOUNT INSTALLATION

1

Note: this basin can only be installed into new cabinetry & benchtops by a licensed tradesperson.

The sink must be available to tradespeople for taking measurements at time of manufacture. **ABI is unable to provide templates due to variations in the material of the product ($\pm 5\text{mm}$).**

Allow for the cabinetry to be designed so the sink front is sitting proud of cabinetry

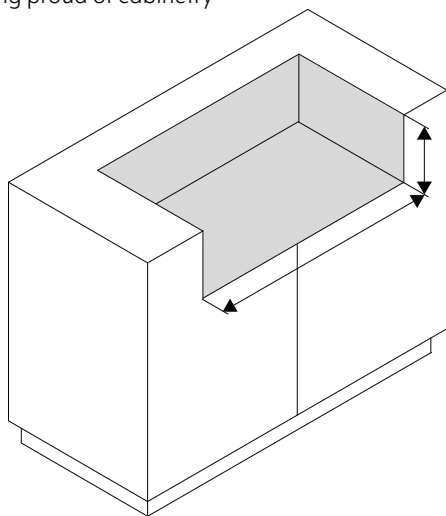

2

Mount the sink into the cabinet shelf ensuring the sink is level with the cabinet top.

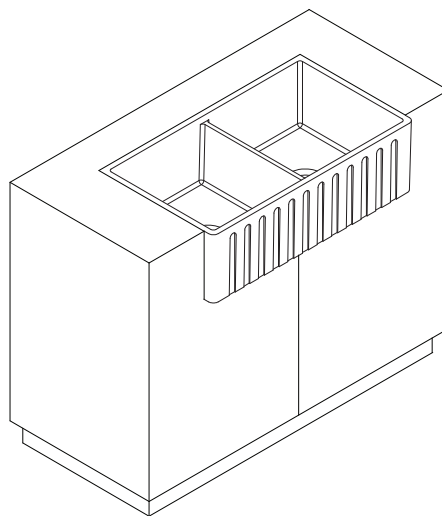

3

Cut the bench-top using the external measurements of the sink perimeter in conjunction with the desired sink overhang and cabinetry shelf.

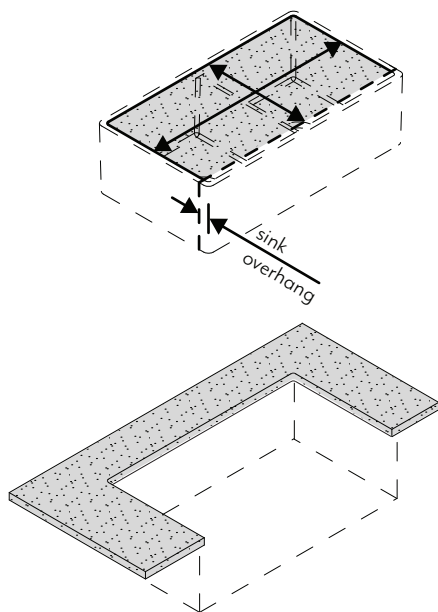

4

Install the benchtop & apply adhesive to sink perimeter. Wipe away any excess adhesive sealant.

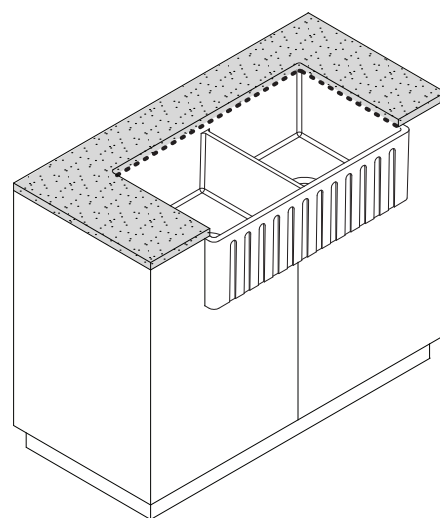

Regularly clean with mild liquid detergent or soap and water.



DO NOT use cream cleaners or bleach. These substances are abrasive.



DO NOT use cleaning pads with abrasive surfaces as this may scratch the material.

INSTALLATION GUIDE

This product must be installed by a licensed plumber.
This is a general installation guide - there are many factors that are involved that can alter the installation method.
This product install must comply with AS/NZS 3500.



FLUSHMOUNT INSTALLATION

1

Note: this basin can only be installed into new cabinetry & benchtops by a licensed tradesperson.

The sink must be available to tradespeople for taking measurements at time of manufacture. **ABI is unable to provide templates due to variations in the material of the product ($\pm 5\text{mm}$).**

Allow for the cabinetry to be designed so the sink front is sitting proud of cabinetry & for additional depth of the benchtop to marry up with the level of the flushmount sink.

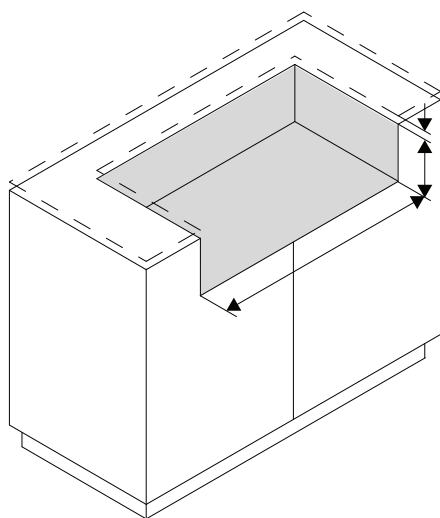

2

Mount the sink into the cabinet shelf.

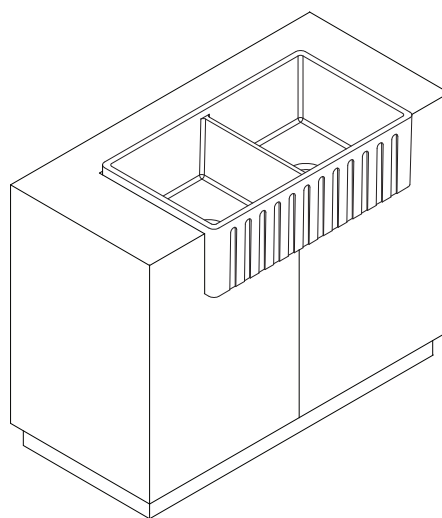

3

Cut the benchtop using the external measurements of the sink perimeter in conjunction with the desired sink overhang and cabinetry shelf.

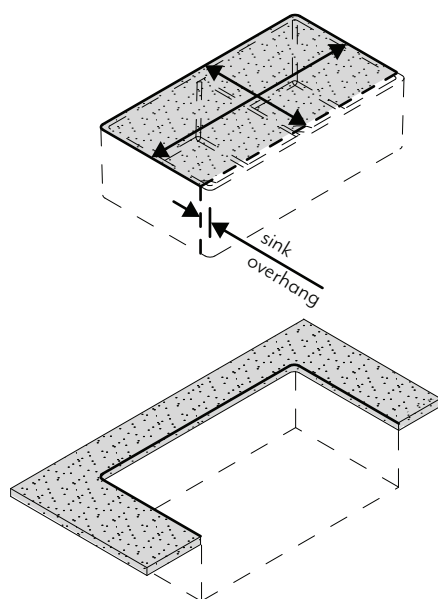

4

Install the benchtop & apply adhesive to sink perimeter. Wipe away any excess adhesive sealant.

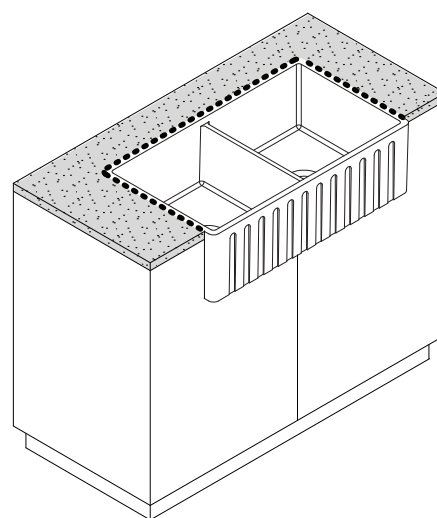

Regularly clean with mild liquid detergent or soap and water.



DO NOT use cream cleaners or bleach. These substances are abrasive.



DO NOT use cleaning pads with abrasive surfaces as this may scratch the material.