

Top View

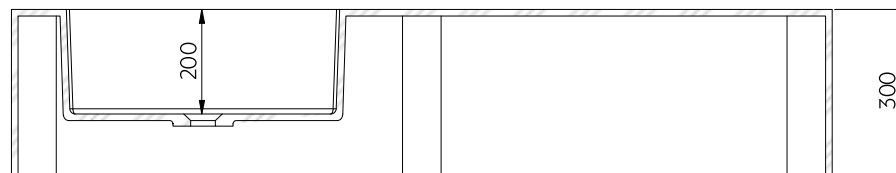

Section A : A

Note: Dimensions are nominal measurements only

SPECIFICATIONS

RECOMMENDED USE

Domestic

MATERIAL

Solid Surface

INSTALLATION

Wall Mount, recommended with Wall Mount Spout/Mixer

OVERFLOW

No

CAPACITY

28L

RIM THICKNESS

50mm at Front and Back
100mm at Side

INSTALLATION GUIDE

This product must be installed by a licensed tradesperson.

This is a general installation guide - there are many factors that are involved that can alter the installation method. This product install must comply with the standards in your respective country and must be adhered to by your licensed tradesperson.



- 1 Check the desired height of basin from floor.

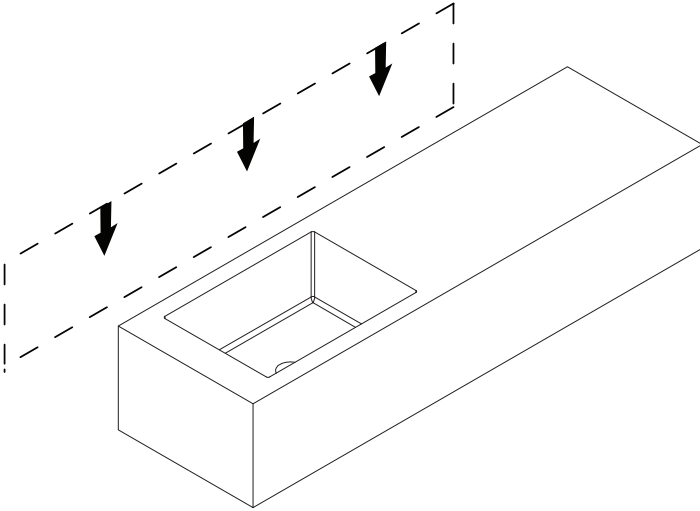

- 2 Fit waste and trap to basin.

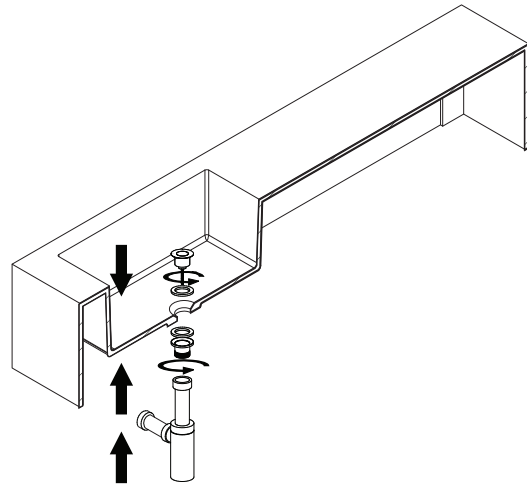

- 3 Hold basin against wall aligning outlet of trap with waste pipe. Extend telescopic trap up or down to desired height and cut waste to suit trap.

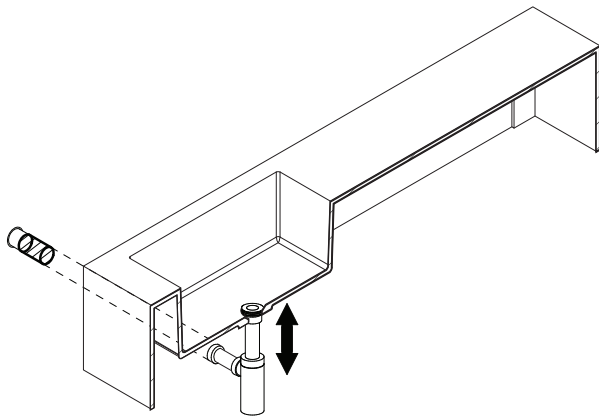

- 4 If correct height and position is suitable, level to top of the basin and mark out desired position. Drill hole through the back of basin into structure within wall. Use a wood drill bit at maximum 450mm centres. Fix basin into structural support in the wall. **ABI takes no responsibility if basin is not fixed into wall structure.**

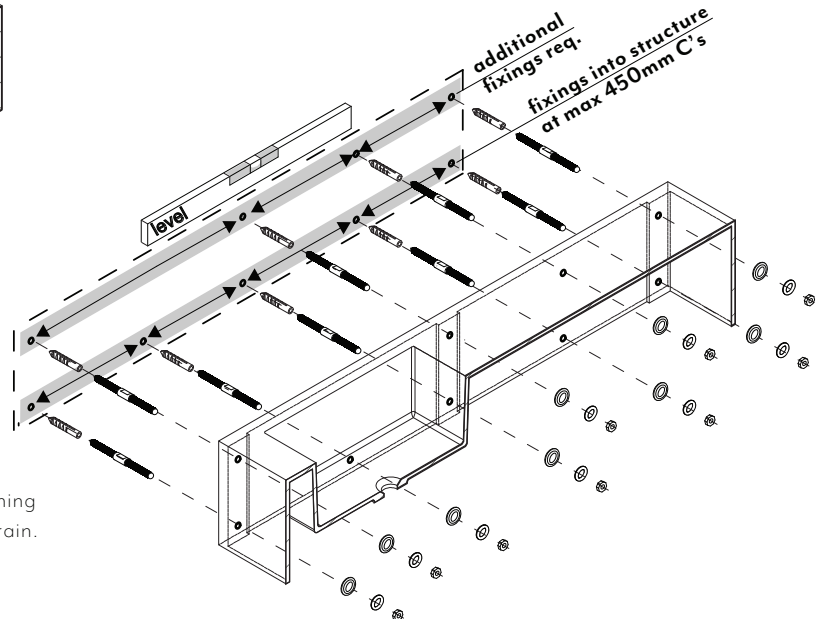

- 5 Secure plumbing to basin and wall outlet. Test by running water through the waste. Place the cover plate over drain. Silicone top and sides of basin if necessary.

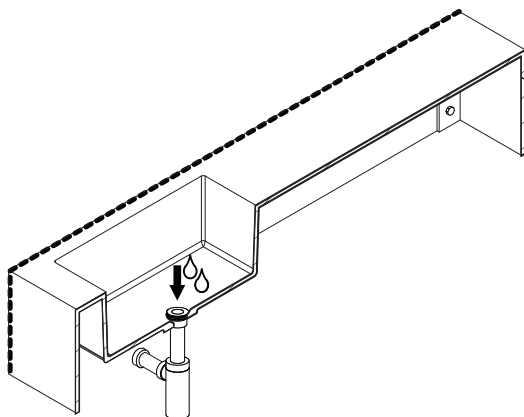

Regularly clean with mild liquid detergent or soap and water.



DO NOT use cream cleaners or bleach. These substances are abrasive.



DO NOT use cleaning pads with abrasive surfaces as this may scratch the material.

IN THE BOX		9 x Wall plug		9 x Metal washer
		9 x Hanger bolt		9 x Nut
		9 x Plastic washer		1 x Basin