

**Note:** Dimensions are nominal measurements only

## SPECIFICATIONS

### RECOMMENDED USE

Domestic

### MATERIAL

Solid Brass

### TEMPERATURE RATING

Maximum continuous working temperature 75°C  
If the water temperature exceeds 75°C, an approved tempering valve must be fitted

### PRESSURE RATING

Recommended minimum working pressure 150kPa  
Recommended maximum working pressure 500kPa  
Hot and cold water inlet pressure should be equal

### SUITABLE HOT WATER UNITS

Storage tank: Yes  
Continuous Flow: Yes  
Gravity Feed: Not suitable

### STANDARDS

WELS 5 Star, 6L/min, T36815

# INSTALLATION GUIDE

**Note:** This product must be installed by a licensed plumber. This is a general installation guide - there are many factors involved that can alter the installation method. **AU/NZ:** For installations within Australia and New Zealand, this product must be installed in compliance with AS/NZS 3500. **UK:** For installations in the United Kingdom this product must be installed in compliance with the Water Supply (Water Fittings) Regulations and Water Supply (Water Fittings) (Scotland) Byelaws. **Other:** For installations outside these countries, this product must be installed in compliance with the standards in your respective country.



**NOTE:** If your spout is positioned close to the bench or had taps close by - you may not be able to twist it on with the gooseneck spout attached - below are the steps to install your spout without hitting any obstacles.

- 1 Using the allen key, loosen the grub screw.

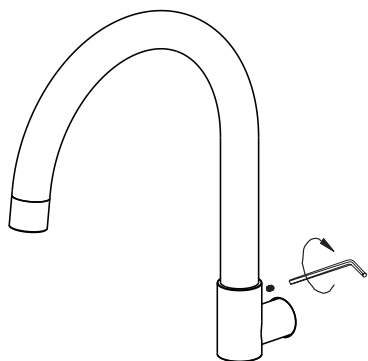

- 2 Make sure the grub screw is loosened enough to release the spout. Release spout by pulling apart from the base. This step is only necessary

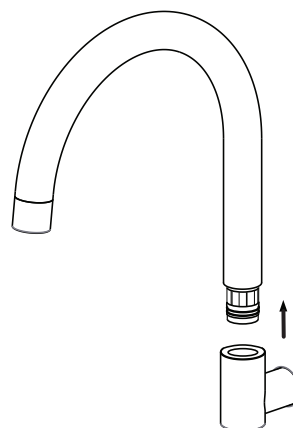

- 3 Rotate the body onto the water outlet (1/2 inch nipple) with teflon tape and firmly tighten.

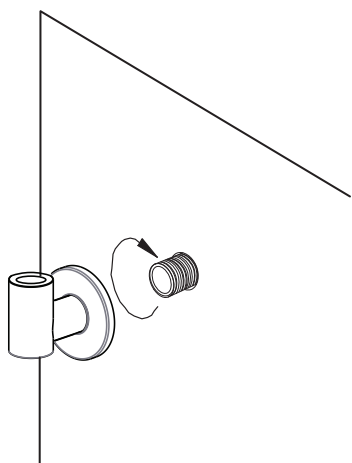

- 4 Insert the gooseneck back into the body and tighten the grub screw. Note: Apply water based lubricant to the O-ring

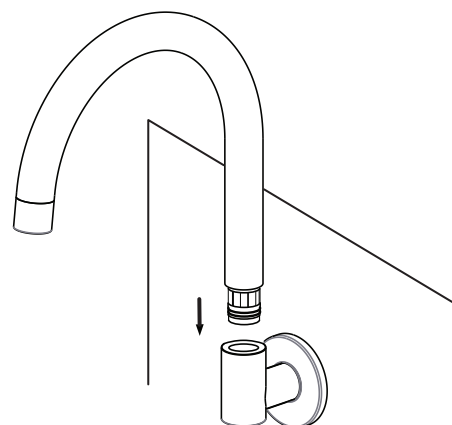

Regularly clean with mild liquid detergent or soap and water



DO NOT use cream cleaners or bleach These substances are abrasive



DO NOT use cleaning pads with abrasive surfaces as this may scratch the material