

Note: Dimensions are nominal measurements only

SPECIFICATIONS

RECOMMENDED USE

Domestic/Commercial

MATERIAL

304 Stainless Steel

INSTALLATION

Undermount, Flush Mount

OVERFLOW

No

CAPACITY

42.16L

INSTALLATION GUIDE

This product must be installed by a licensed plumber.
This is a general installation guide - there are many factors that are involved that can alter the installation method.
This product install must comply with AS/NZS 3500.



UNDERMOUNT INSTALLATION

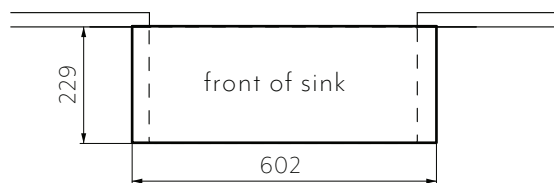

CABINET SINK SHELF SET OUT - UNDERMOUNT

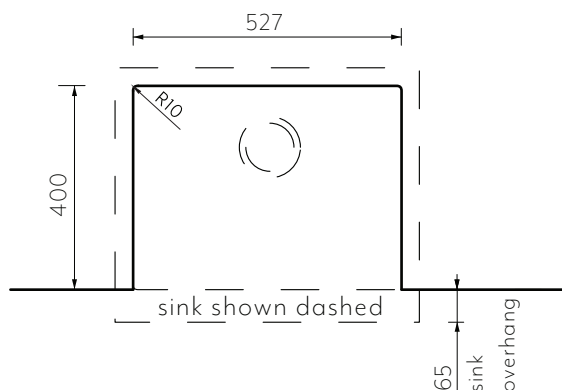

BENCHTOP SINK CUT TEMPLATE - UNDERMOUNT

FLUSHMOUNT INSTALLATION

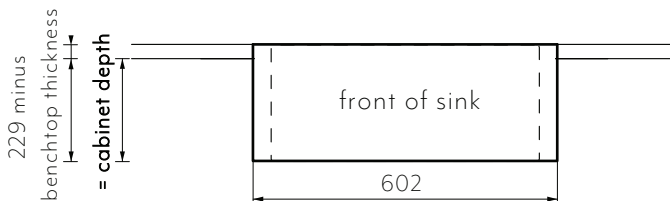

CABINET SINK SHELF SET OUT - FLUSHMOUNT

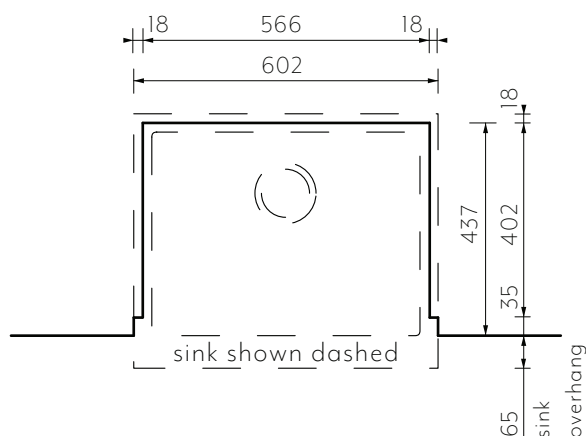

BENCHTOP CUT TEMPLATE - FLUSHMOUNT

RACK DIMENSIONS

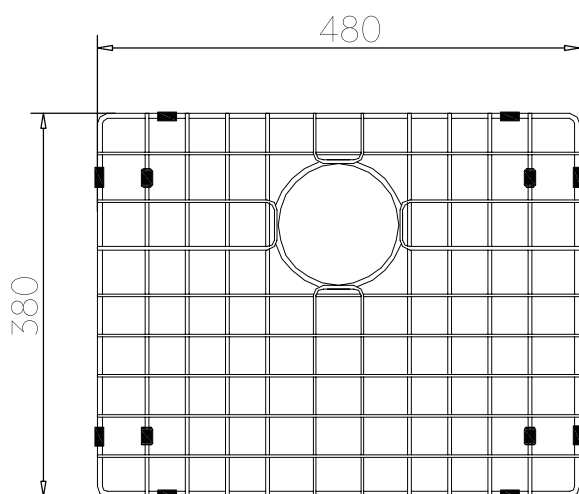

BASKET WASTE

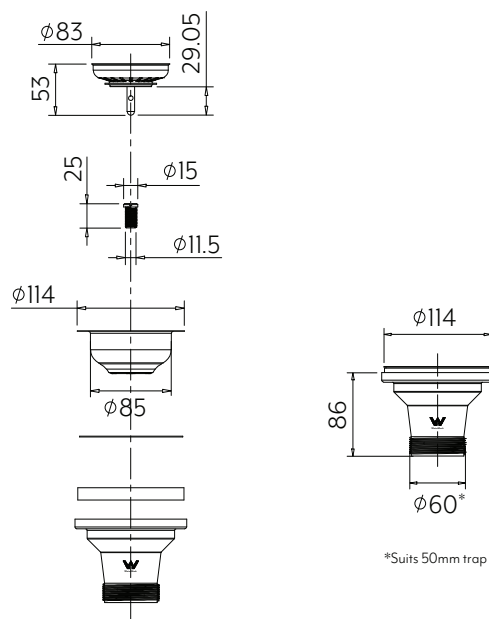

Note: Dimensions are nominal measurements only



Regularly clean with mild liquid detergent or soap and water.



DO NOT use cream cleaners or bleach. These substances are abrasive.



DO NOT use cleaning pads with abrasive surfaces as this may scratch the material.

INSTALLATION GUIDE

This product must be installed by a licensed plumber.
This is a general installation guide - there are many factors that are involved that can alter the installation method.
This product install must comply with AS/NZS 3500.



UNDERMOUNT INSTALLATION

- 1 Note: this basin can only be installed into new cabinetry & benchtops by a licensed tradesperson.

Cabinet maker to refer to cabinet sink shelf set out provided.
Allow for the cabinetry to be designed so the sink front is sitting proud of cabinetry.

- 2 Mount the sink into the cabinet shelf ensuring the sink is level with the cabinet top.

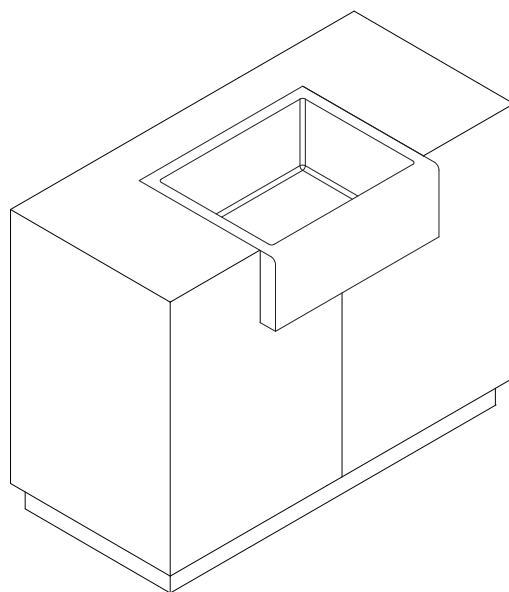
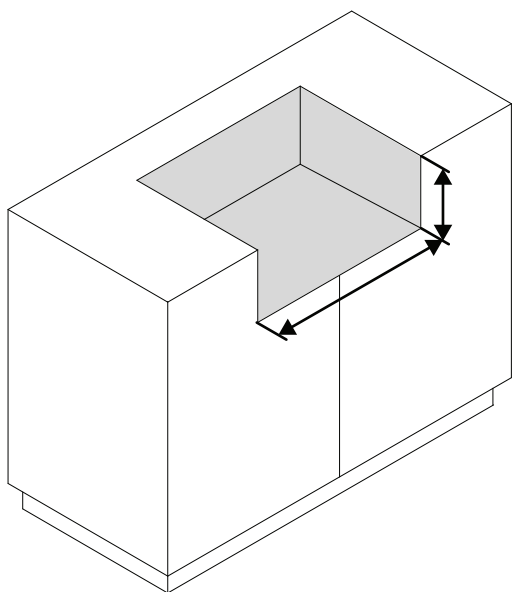

- 3 Cut the benchtop using the cut template dimensions provided in conjunction with the sink overhang and cabinetry shelf dimensions.

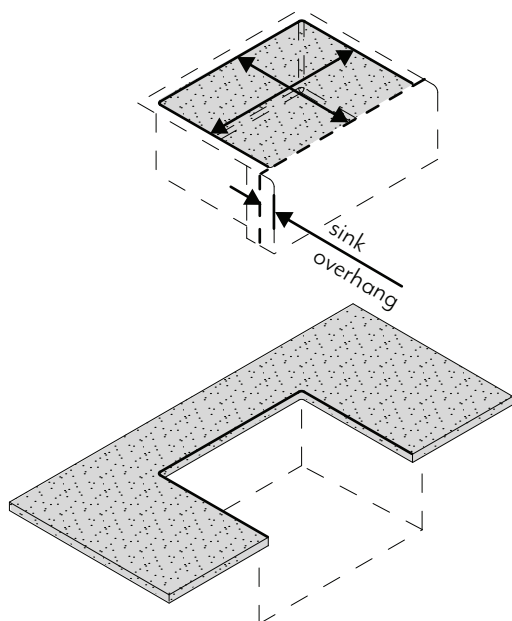

- 4 Install the benchtop & apply adhesive to sink perimeter. Wipe away any excess adhesive sealant.

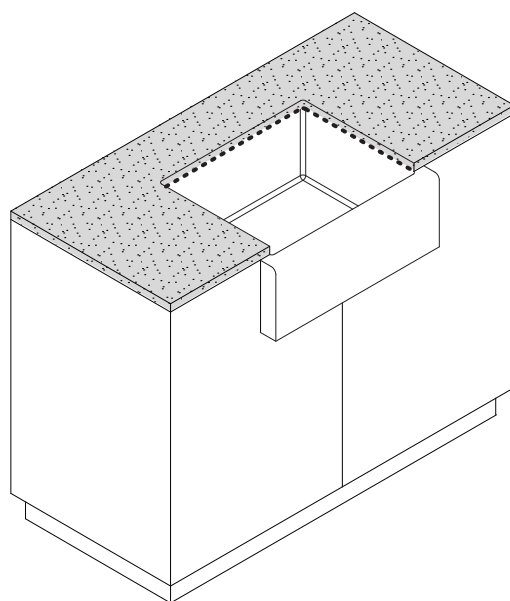

Regularly clean with mild liquid detergent or soap and water.



DO NOT use cream cleaners or bleach. These substances are abrasive.



DO NOT use cleaning pads with abrasive surfaces as this may scratch the material.

INSTALLATION GUIDE

This product must be installed by a licensed plumber.
This is a general installation guide - there are many factors that are involved that can alter the installation method.
This product install must comply with AS/NZS 3500.



FLUSHMOUNT INSTALLATION

- 1 Note: this basin can only be installed into new cabinetry & benchtops by a licensed tradesperson.

Cabinet maker to refer to cabinet sink shelf set out provided.
Allow for the cabinetry to be designed so the sink front is sitting proud of cabinetry.

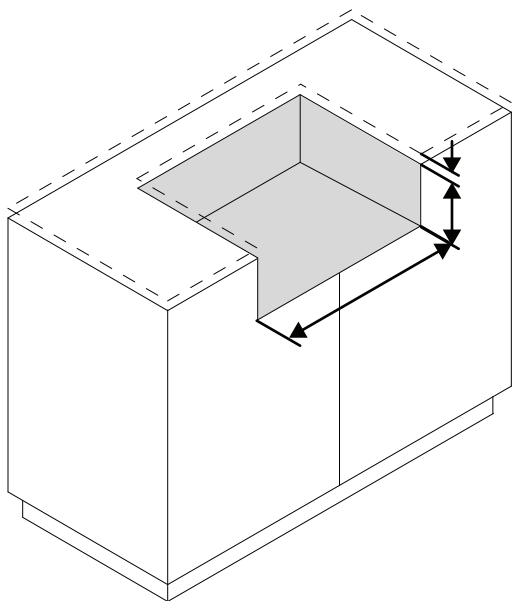

- 2 Mount the sink into the cabinet shelf.

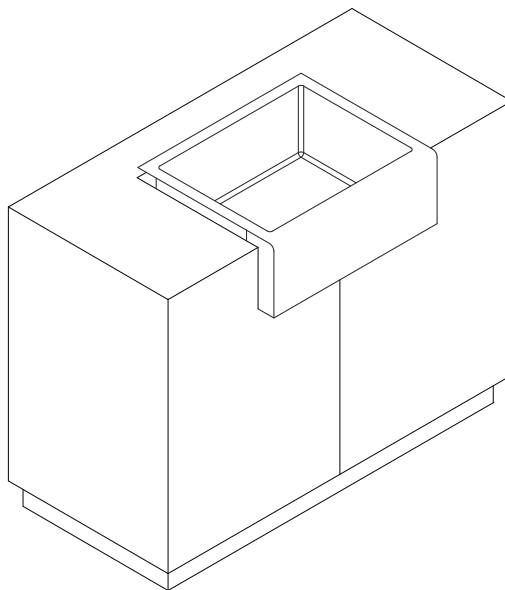

- 3 Cut the benchtop using the cut template dimensions provided in conjunction with the sink overhang and cabinetry shelf dimensions.

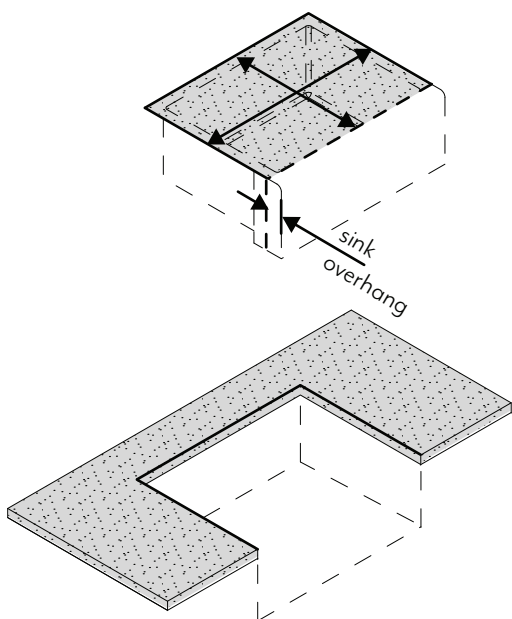

- 4 Install the benchtop & apply adhesive to sink perimeter. Wipe away any excess adhesive sealant.

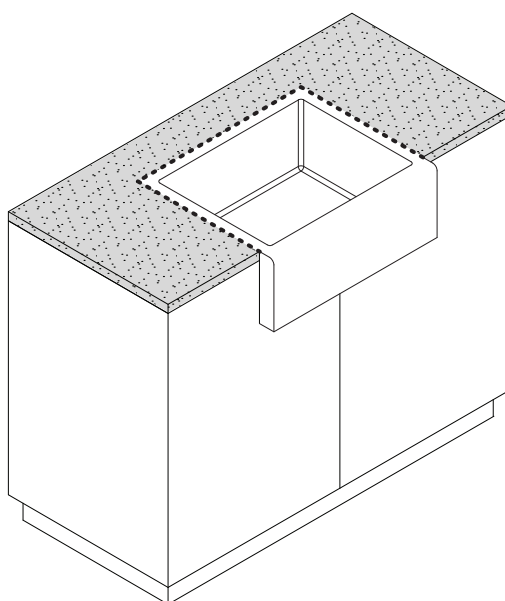

Regularly clean with mild liquid detergent or soap and water.



DO NOT use cream cleaners or bleach. These substances are abrasive.



DO NOT use cleaning pads with abrasive surfaces as this may scratch the material.