

**Note:** Dimensions are nominal measurements only

## SPECIFICATIONS

### RECOMMENDED USE

Domestic/Commercial

### MATERIAL

Pan: Glazed porcelain

Seat: Soft close - Hardened Polypropylene (PP)

### INSTALLATION

Floor Mounted

P-trap or S-trap (S-trap included)

### PRESSURE RATING

Recommended minimum working pressure 150kPa

Recommended maximum working pressure 500kPa

Hot and cold water inlet pressure should be equal

### TEMPERATURE RATING

Maximum continuous working temperature 75°C If the water temperature exceeds 75°C, an approved tempering valve must be fitted

### STANDARDS

WELS 4 star, Full Flush 4.6L, Half Flush 3.0L, Average Flush 3.3L, L08448

# INSTALLATION GUIDE

**Note:** This product must be installed by a licensed plumber. This is a general installation guide - there are many factors involved that can alter the installation method. **AU/NZ:** For installations within Australia and New Zealand, this product must be installed in compliance with AS/NZS 3500. **UK:** For installations in the United Kingdom this product must be installed in compliance with the Water Supply (Water Fittings) Regulations and Water Supply (Water Fittings) (Scotland) Byelaws. **Other:** For installations outside these countries, this product must be installed in compliance with the standards in your respective country.



- ① Align S trap adaptor with pipe riser and fix wall bracket accordingly. Ensure a **140mm** set out from wall to pipe centre.

**Note:** Use appropriate fixings according to wall finish.

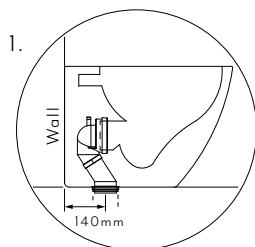
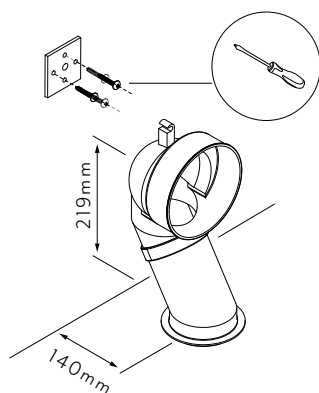

**Note:** If you cannot achieve a 140mm set out, visit your local plumbing store.

- ② Using a spanner, tighten nuts to fasten threaded rod to wall bracket and S trap adaptor.

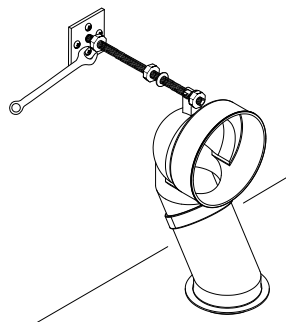

- ③ Place pan collar onto S trap adaptor outlet.

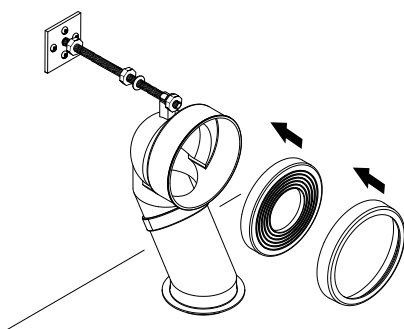

- ④ Cut flush pipe to suit.

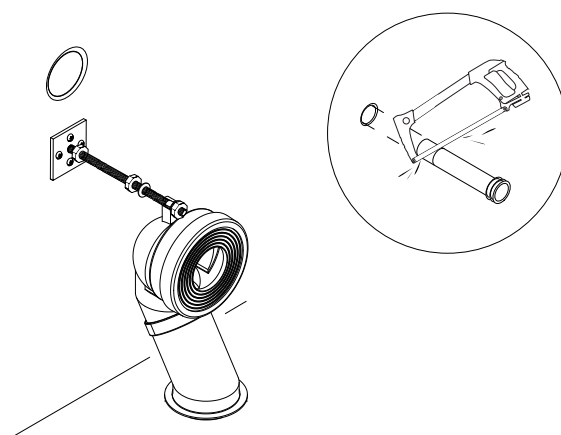

- ⑤ 1. File flush pipe and insert into o-ring seal socket in wall.  
2. Push pan onto S trap adaptor and flush pipe.

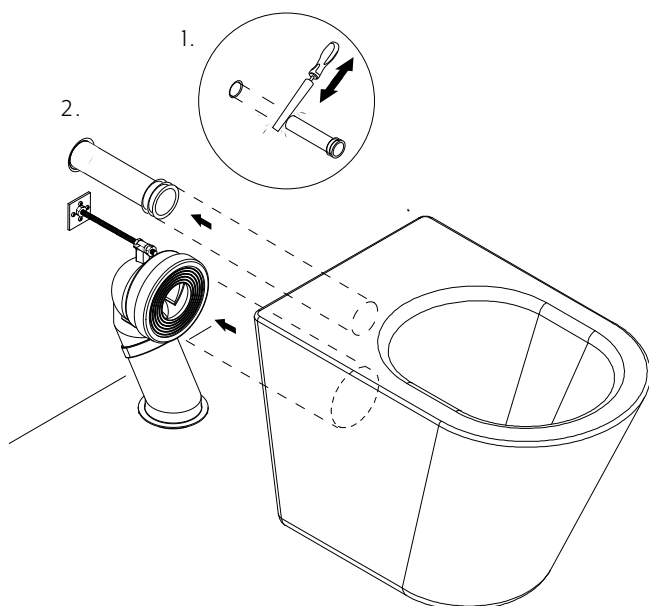

- ⑥ 1. Push expansion plugs into pan holes.  
2. Use a screwdriver to attach hinges.  
3. Adjust hinges and push seat on

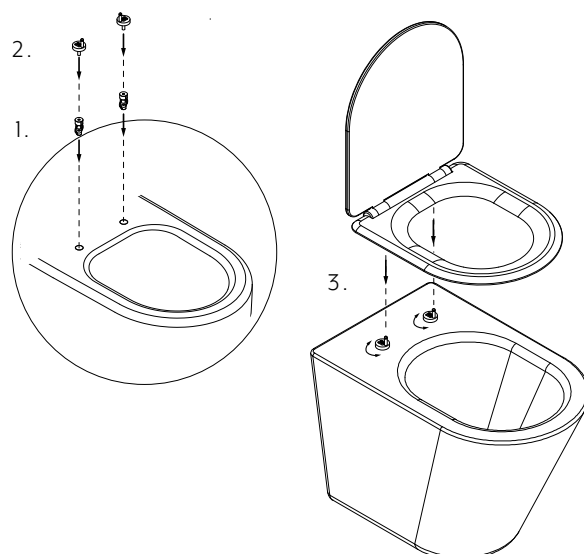

# INSTALLATION GUIDE

**Note:** This product must be installed by a licensed plumber. This is a general installation guide - there are many factors involved that can alter the installation method. **AU/NZ:** For installations within Australia and New Zealand, this product must be installed in compliance with AS/NZS 3500. **UK:** For installations in the United Kingdom this product must be installed in compliance with the Water Supply (Water Fittings) Regulations and Water Supply (Water Fittings) (Scotland) Byelaws. **Other:** For installations outside these countries, this product must be installed in compliance with the standards in your respective country.



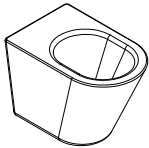

## IN THE BOX

BOX 1

  
1x pan

  
2x screws

  
1x toilet seat

  
2x hinges

  
2x toilet clips

  
2x expansion plug

BOX 2

  
1x S trap adaptor

  
2x washers

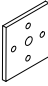
  
1x wall bracket

  
3x nuts

  
1x threaded rod

  
4x screws