

# ALIRO ACCESSIBLE 140° GRAB RAIL SET

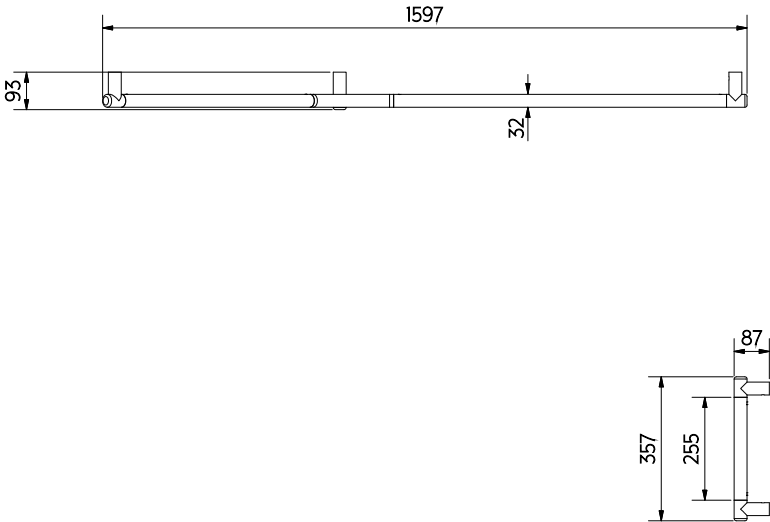

Top View

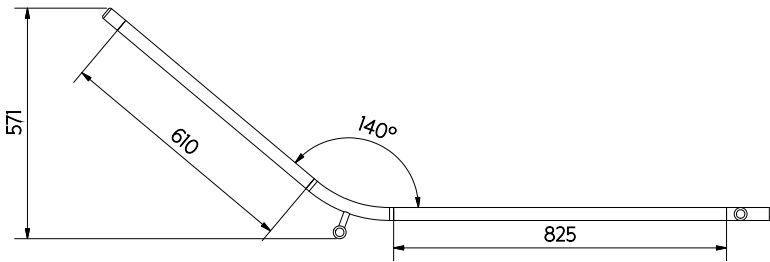

Front View

**Note:** Dimensions are nominal measurements only

## SPECIFICATIONS



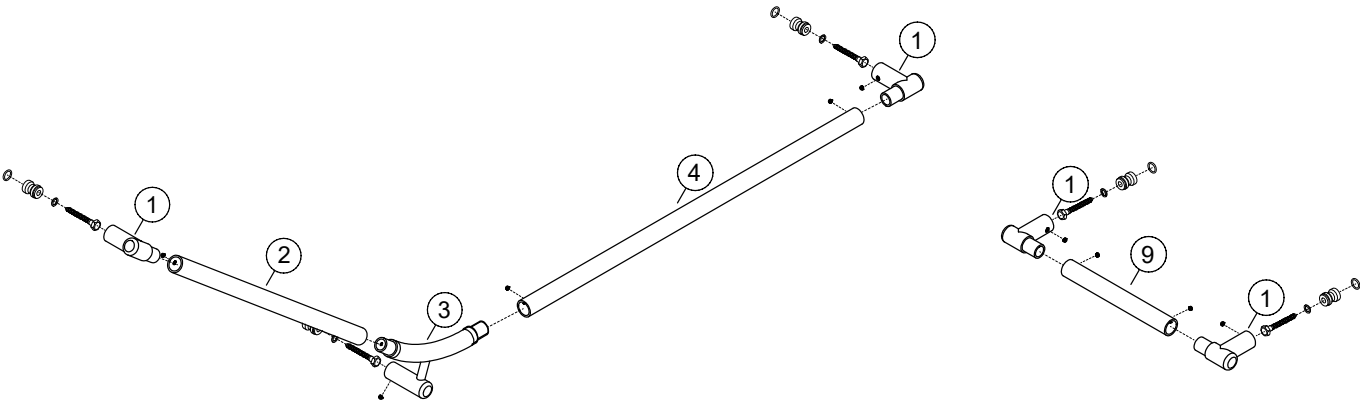

RECOMMENDED USE	Domestic/Commercial
MATERIAL	316 Stainless Steel
MOUNTING HARDWARE INCLUDED	Yes, M10 x 75mm Coach Screw
STANDARDS	AS1428.1:2021



**140° Accessible Grab Rail Kit  
(numbered components)**

- |                   |                 |
|-------------------|-----------------|
| ① End Bracket x 4 | ④ 825mm Rail x1 |
| ② 610mm Rail x1   | ⑨ 225mm Rail x1 |
| ③ 140° Bracket x1 |                 |

**Fixing Kit  
(unnumbered components)**

- |                                                                                       |                                                                                       |                                                                                       |
|---------------------------------------------------------------------------------------|---------------------------------------------------------------------------------------|---------------------------------------------------------------------------------------|
|    |  |  |
| Fixing Bracket x 5                                                                    | Coach Screw x 5                                                                       | Grub Screw x 11                                                                       |
|  |  |                                                                                       |
| Washer x 5                                                                            | O Ring x 5                                                                            |                                                                                       |

**ALTERNATIVE INSTALL FORMAT**

Modularity of product permits installation on either the left or right hand walls.

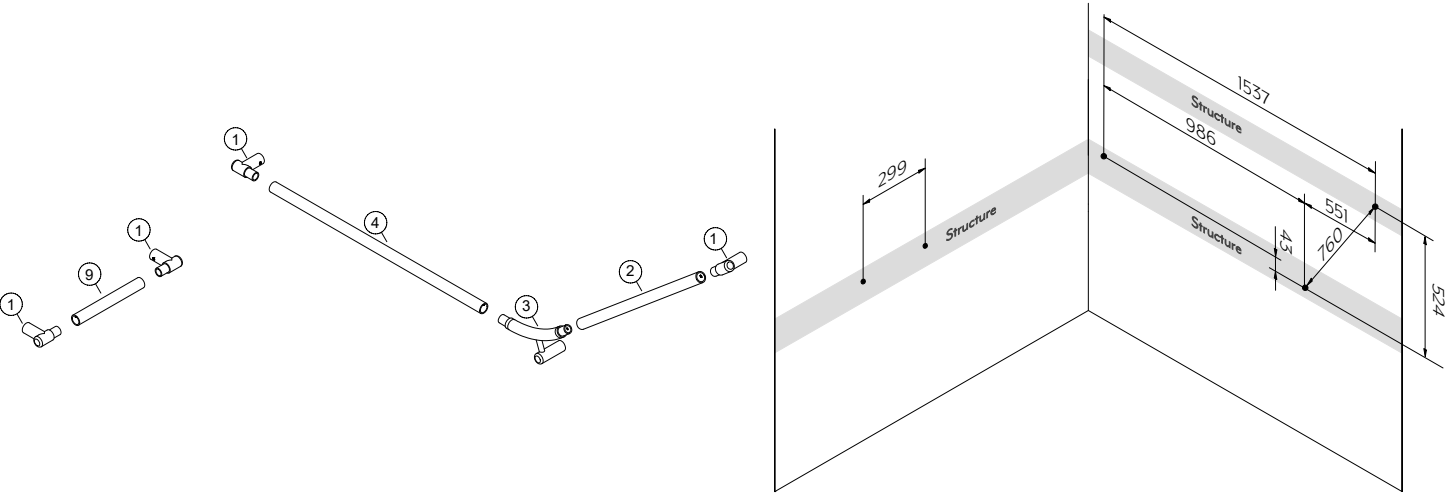

**Note:** Dimensions are nominal measurements only

# INSTALLATION GUIDE



**Note:** This product must be installed by a licensed tradesperson.

**This product's install must comply with AS1428.1 for installation within Australia.** This is a general installation guide - there are many factors that are involved that can alter the installation method. **ABI takes no responsibility if your product is not fixed to adequate wall structure.**

- 1 For rough in, refer to Step 3 for wall structure set out.**  
Set out grab rail in numbered configuration as illustrated below.  
(Numbered indication appears on previous page).

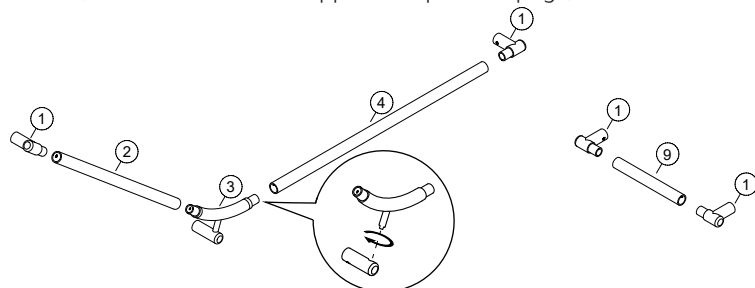

- 3 Mark out fixing points centre to centre, on a level floor,** ensuring grab rail placement meets **AS1428.1:2021 standards.** Refer to alternative install location instructions for opposite wall installation.

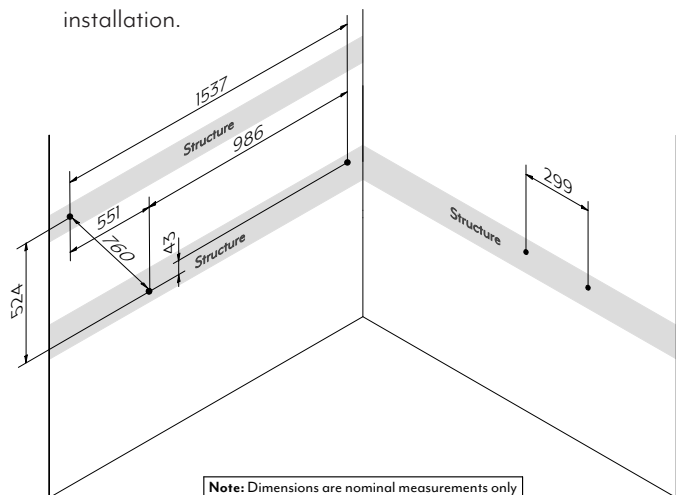

- 2 Fix grab rails to brackets using allen key provided.**  
**Note:** do not tighten grub screws completely, this aids wall mount install process.

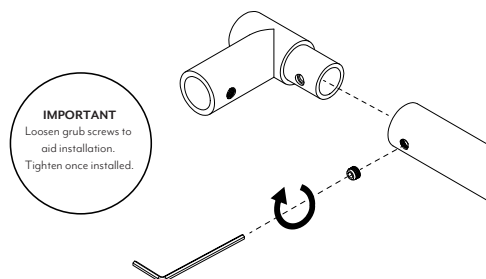

- 4 Align fixing points with rail configuration, using a level, double check fixing location. Drill pilot holes accordingly.**

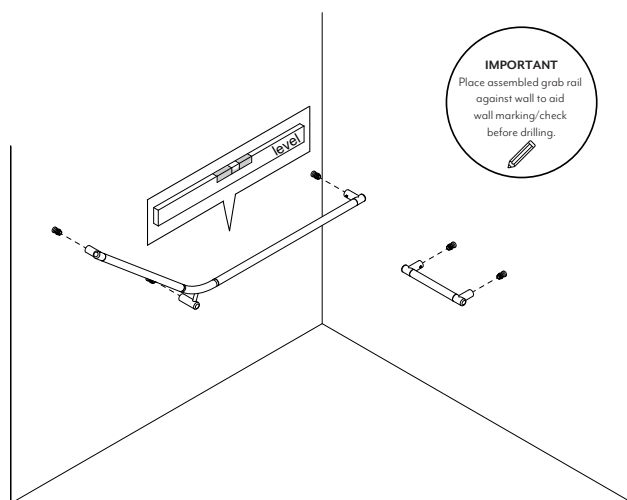

- 5 Secure fixing brackets at previously marked fixing location.** Ensure fixing is level & fixed into appropriate structural support.

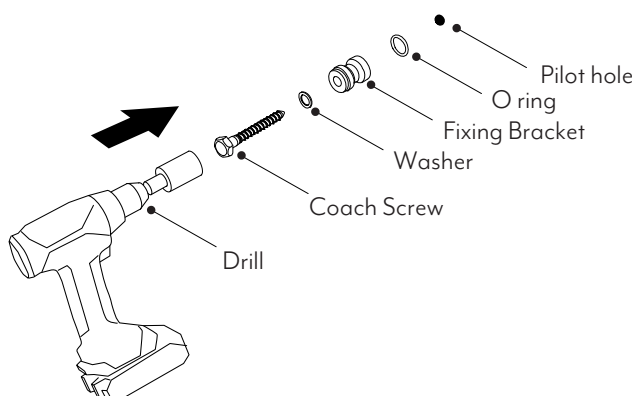

- 6 Slide grab rails onto brackets & fix with grub screw. Ensure all fixings are tight and secure.**

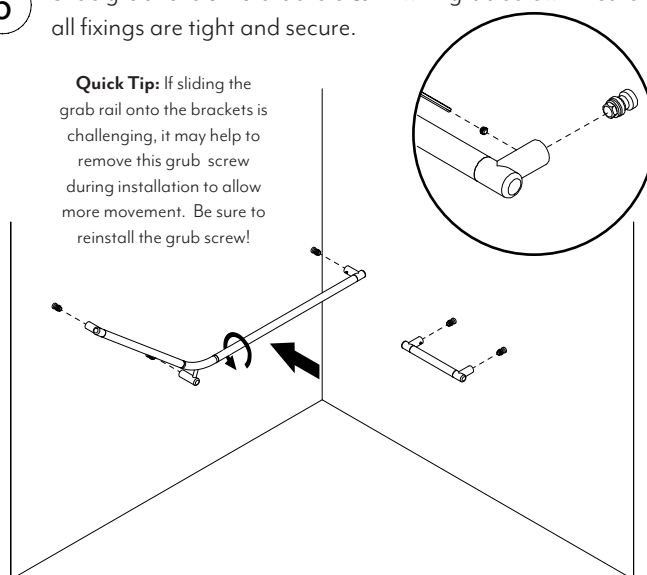

Regularly clean with mild liquid detergent or soap and water.



**DO NOT** use cream cleaners or bleach. These substances are abrasive.



**DO NOT** use cleaning pads with abrasive surfaces as this may scratch the material.