

ADJUSTABLE HAND SHOWER HOLDER & BP

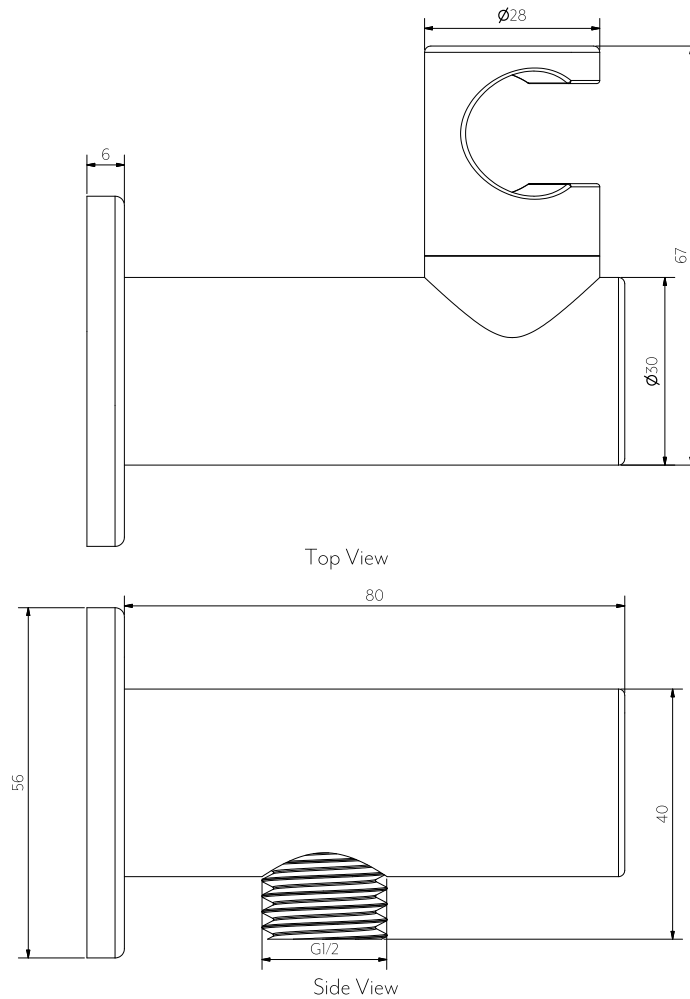

Note: Dimensions are nominal measurements only

SPECIFICATIONS

RECOMMENDED USE

Domestic

MATERIAL

Solid Brass

INSTALLATION GUIDE

This product must be installed by a licensed tradesperson.

This is a general installation guide - there are many factors that are involved that can alter the installation method. This product install must comply with the standards in your respective country and must be adhered to by your licensed tradesperson.



- 1 Slide back plate onto water point.

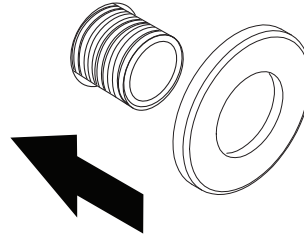

- 2 Apply the teflon tape to the brass outlet pipe. Twist the BP on and hand tighten.

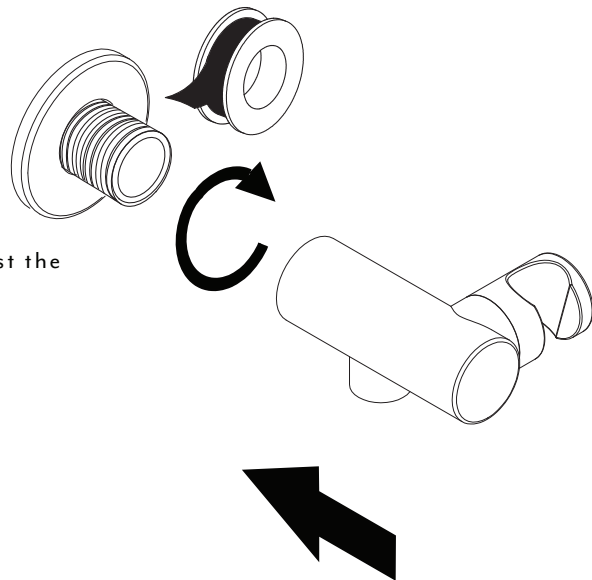

WHAT'S IN THE BOX



1x Back plate

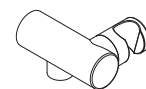

1x BP Body



Regularly clean with mild liquid detergent or soap and water.



DO NOT use cream cleaners or bleach. These substances are abrasive.



DO NOT use cleaning pads with abrasive surfaces as this may scratch the material.